

0940-a

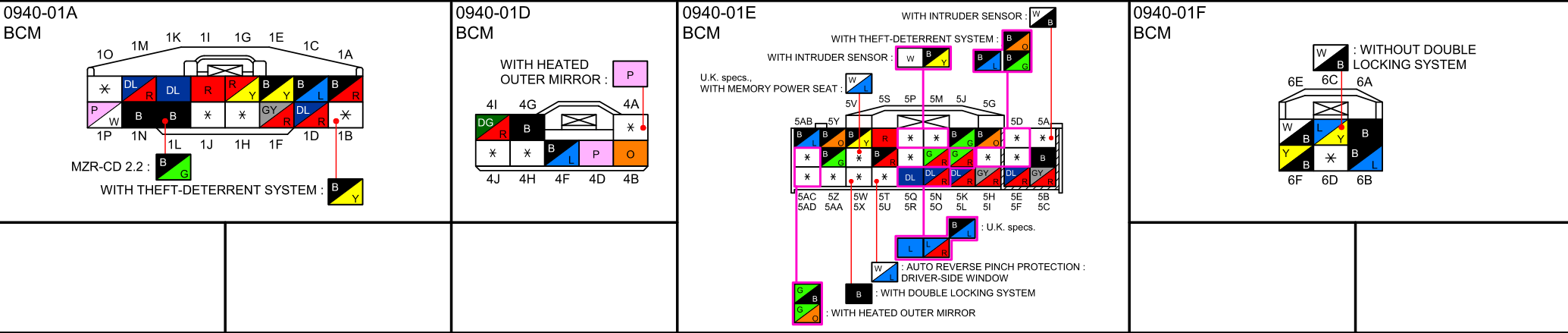

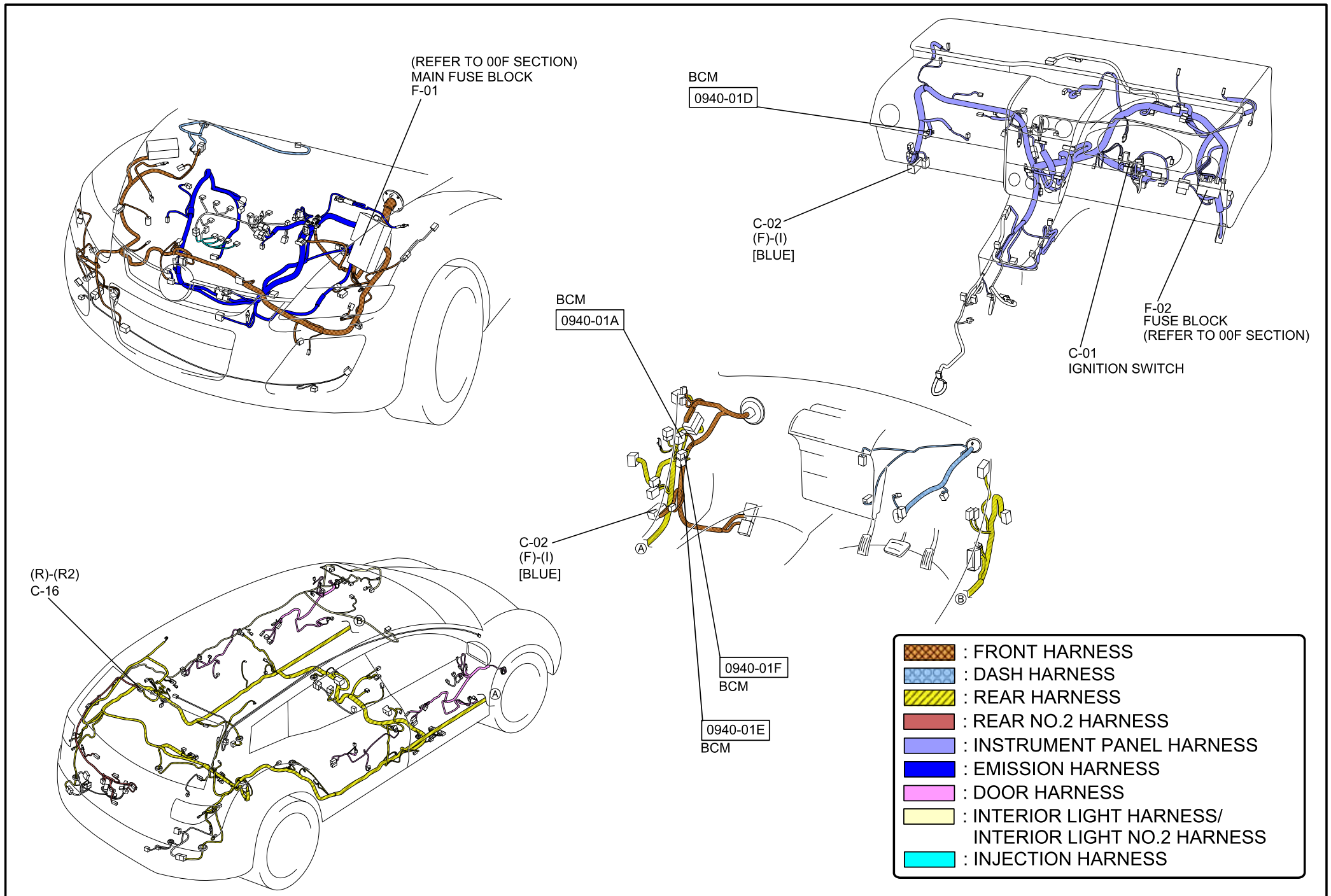

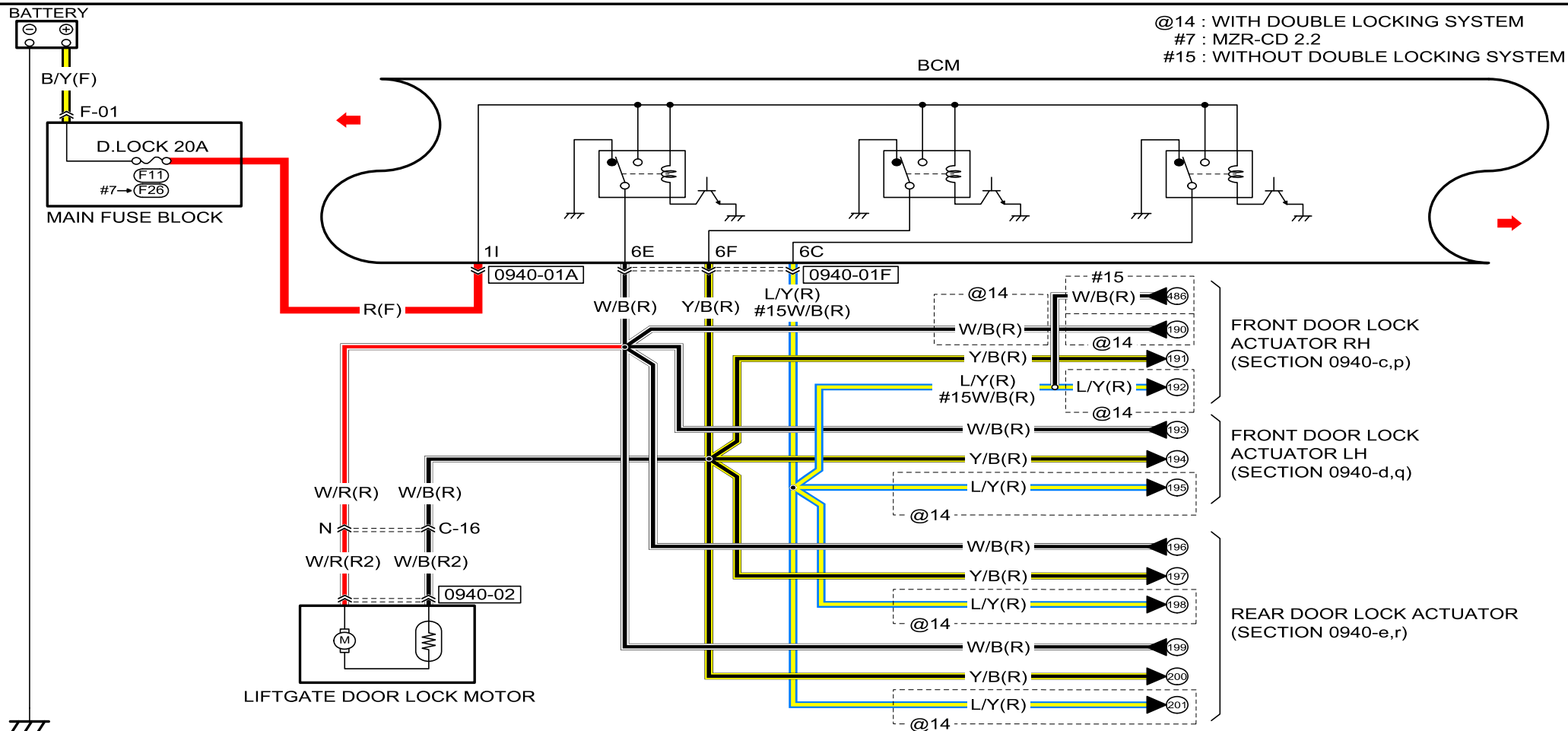

0940-01A
BCM

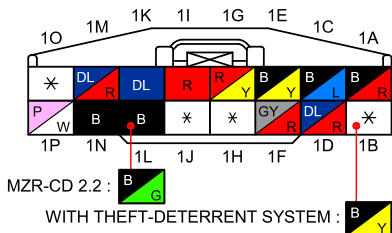

0940-01F
BCM

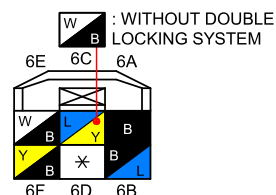

0940-02
LIFTGATE DOOR LOCK MOTOR

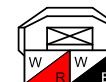

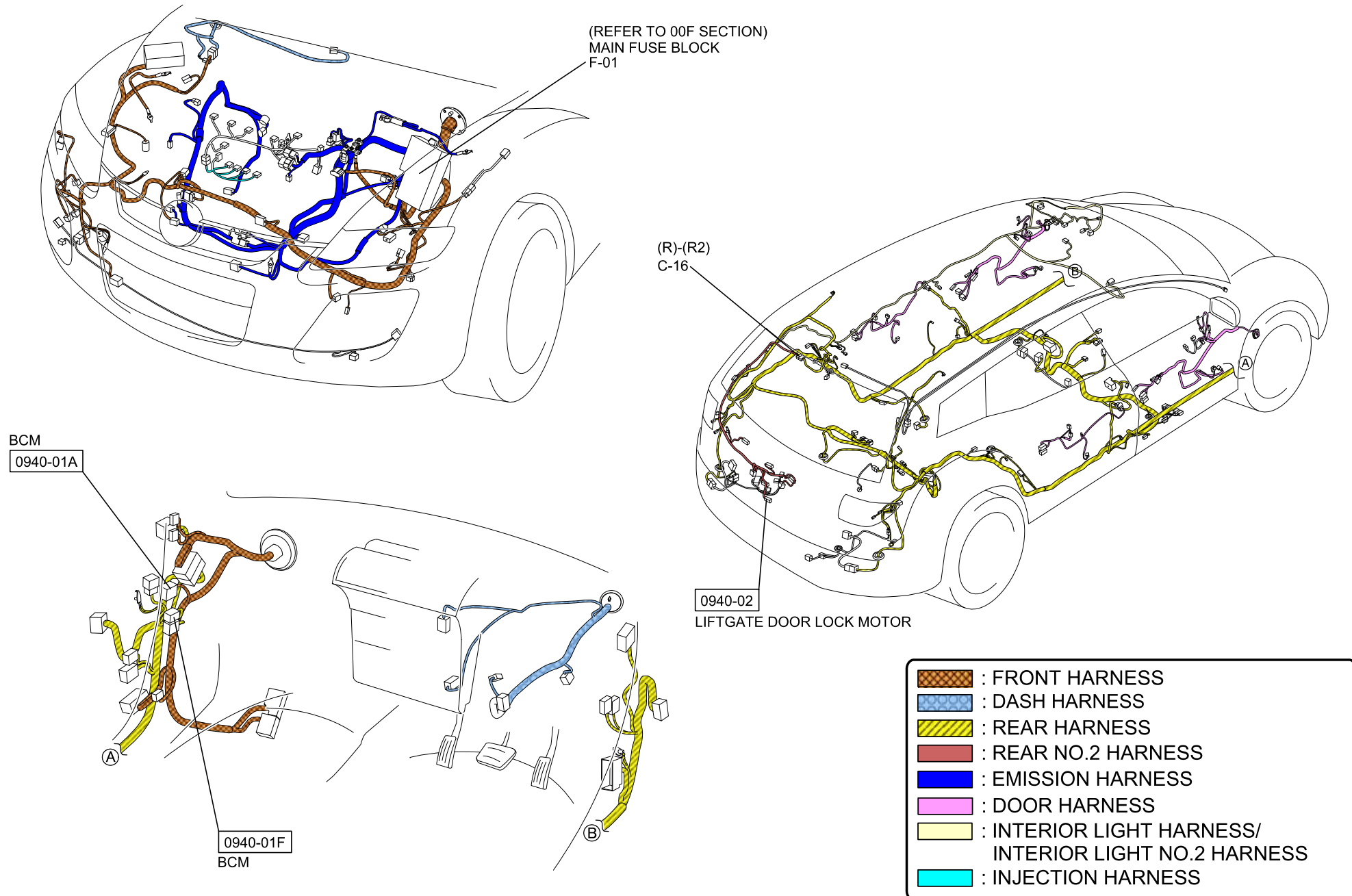

&6 : U.K. specs.

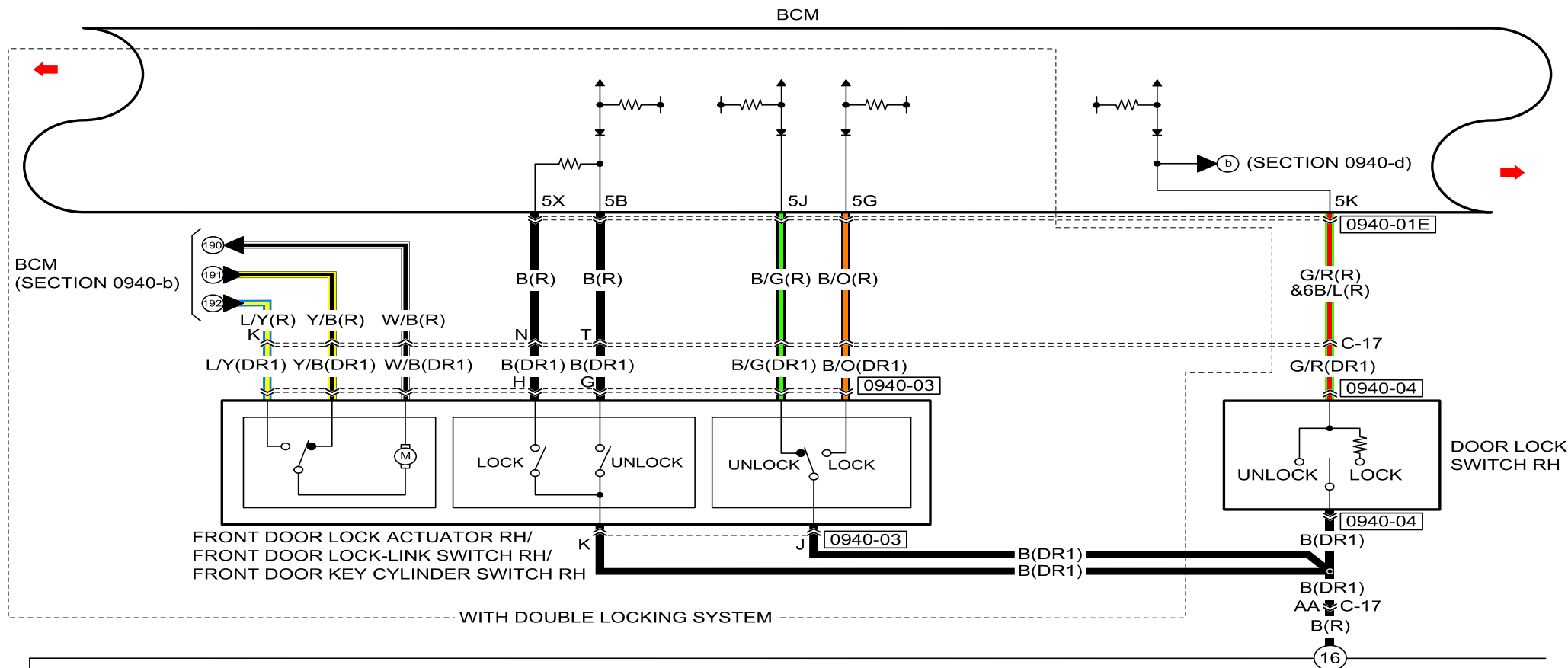

0940-01E
BCM

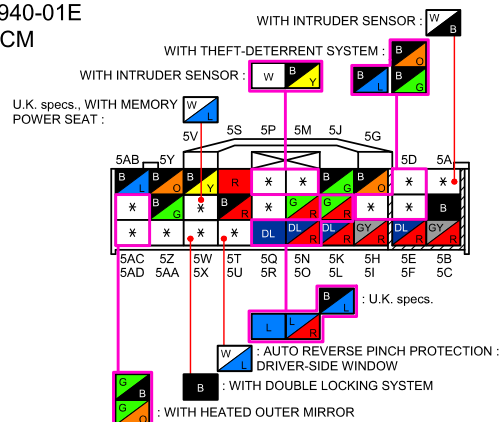

0940-03
FRONT DOOR LOCK ACTUATOR RH/
FRONT DOOR LOCK-LINK SWITCH RH/
FRONT DOOR KEY CYLINDER SWITCH RH

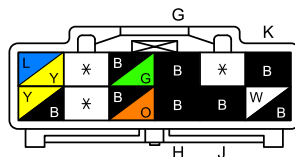

0940-04
DOOR LOCK SWITCH RH

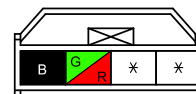

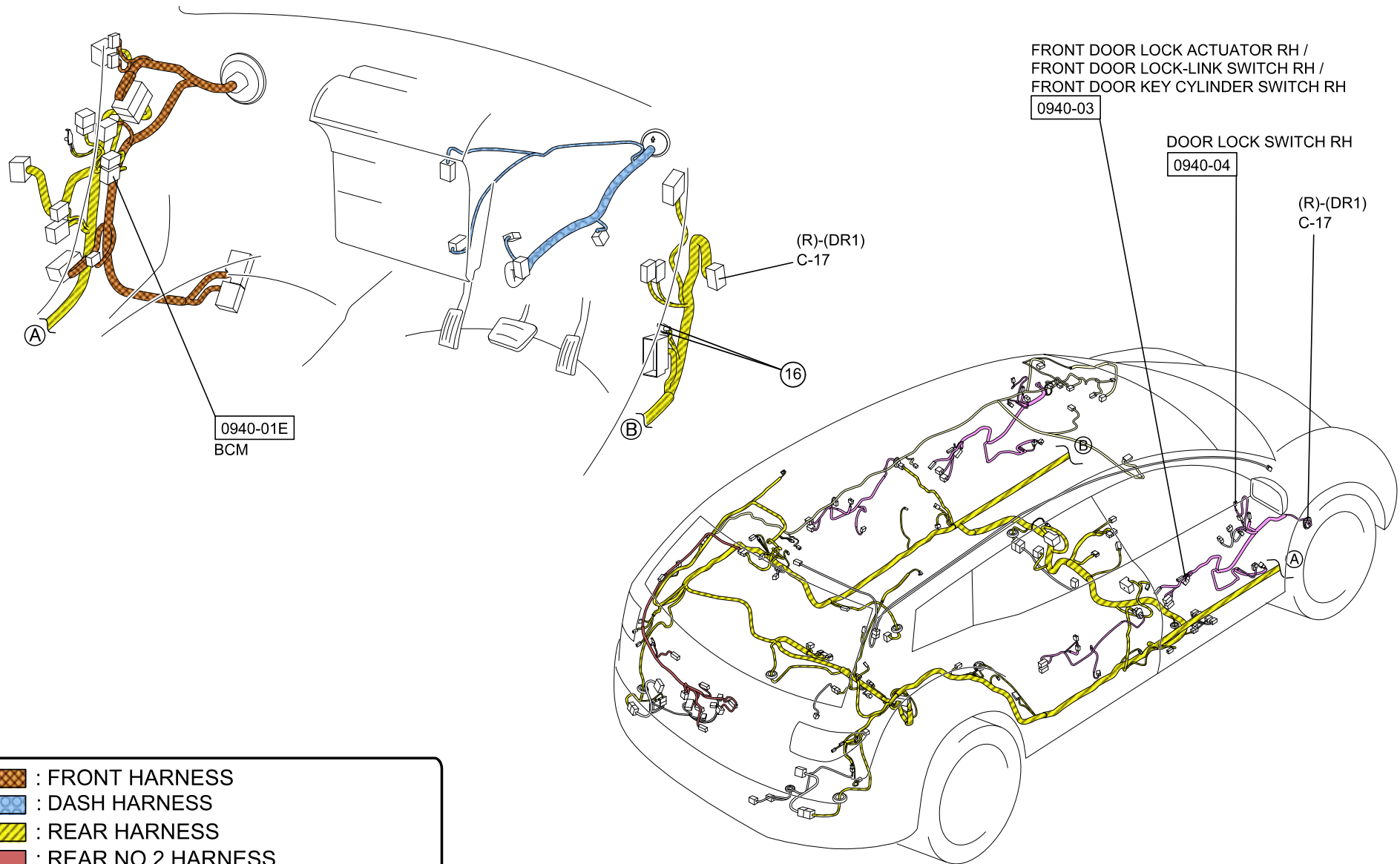

- : FRONT HARNESS
- : DASH HARNESS
- : REAR HARNESS
- : REAR NO.2 HARNESS
- : DOOR HARNESS
- : INTERIOR LIGHT HARNESS/
INTERIOR LIGHT NO.2 HARNESS

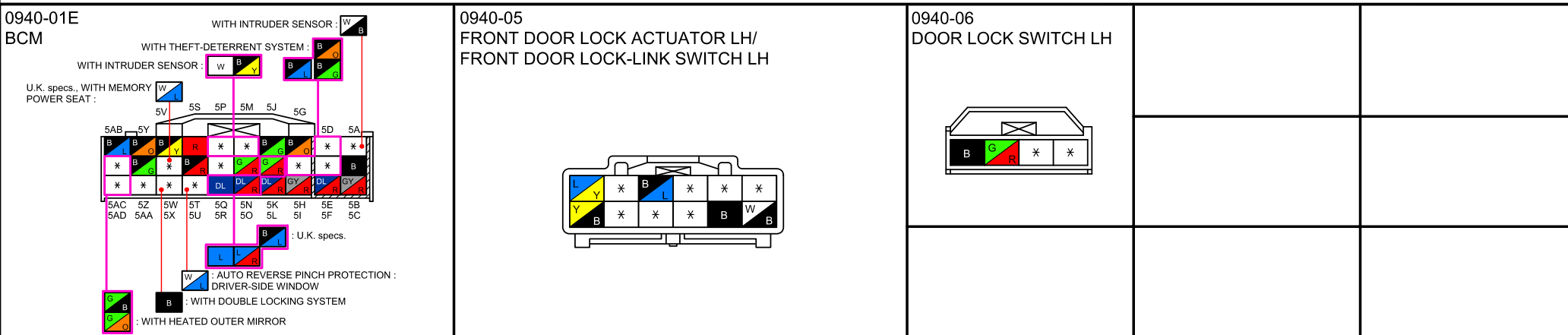

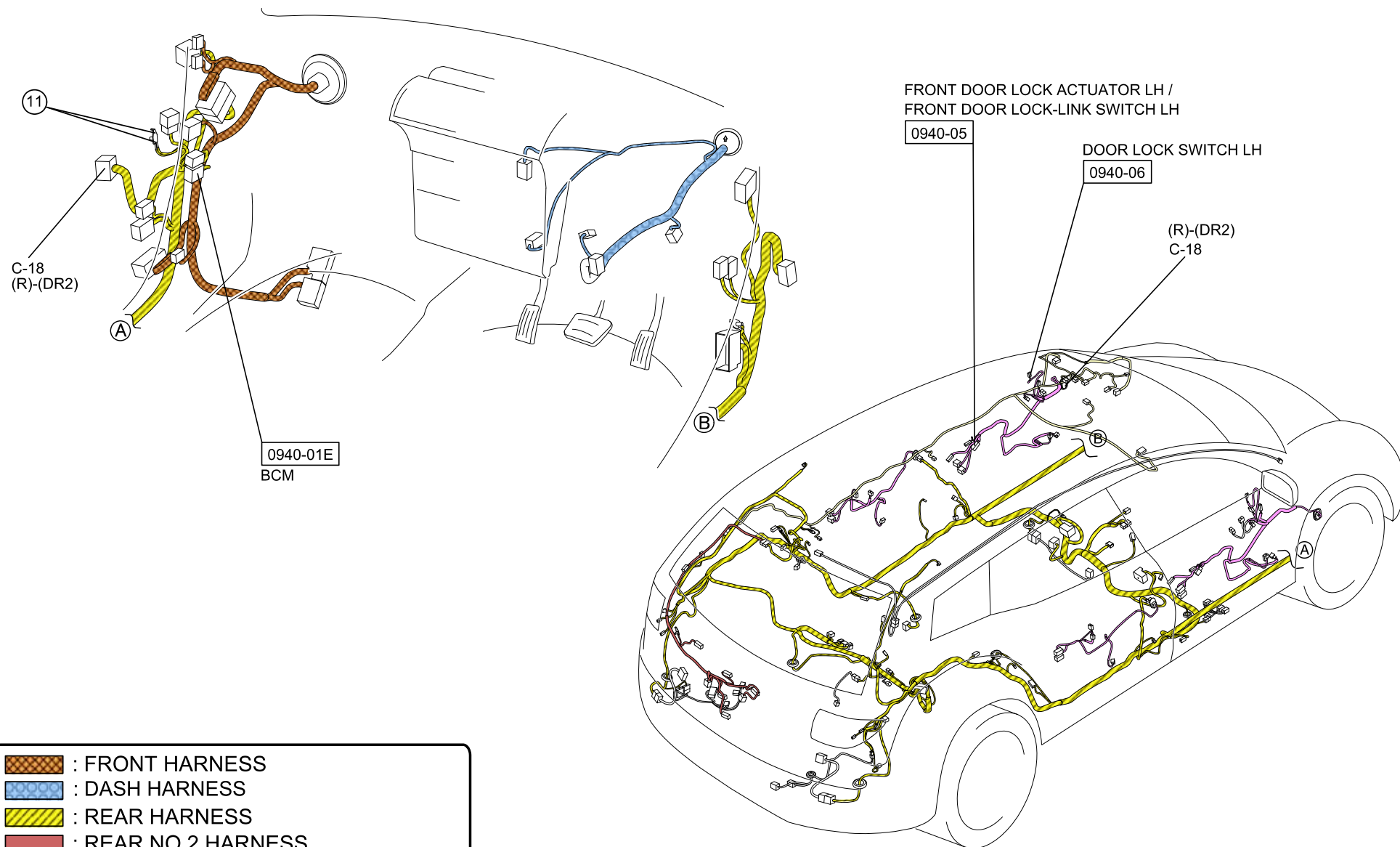

- : FRONT HARNESS
- : DASH HARNESS
- : REAR HARNESS
- : REAR NO.2 HARNESS
- : DOOR HARNESS
- : INTERIOR LIGHT HARNESS/
INTERIOR LIGHT NO.2 HARNESS

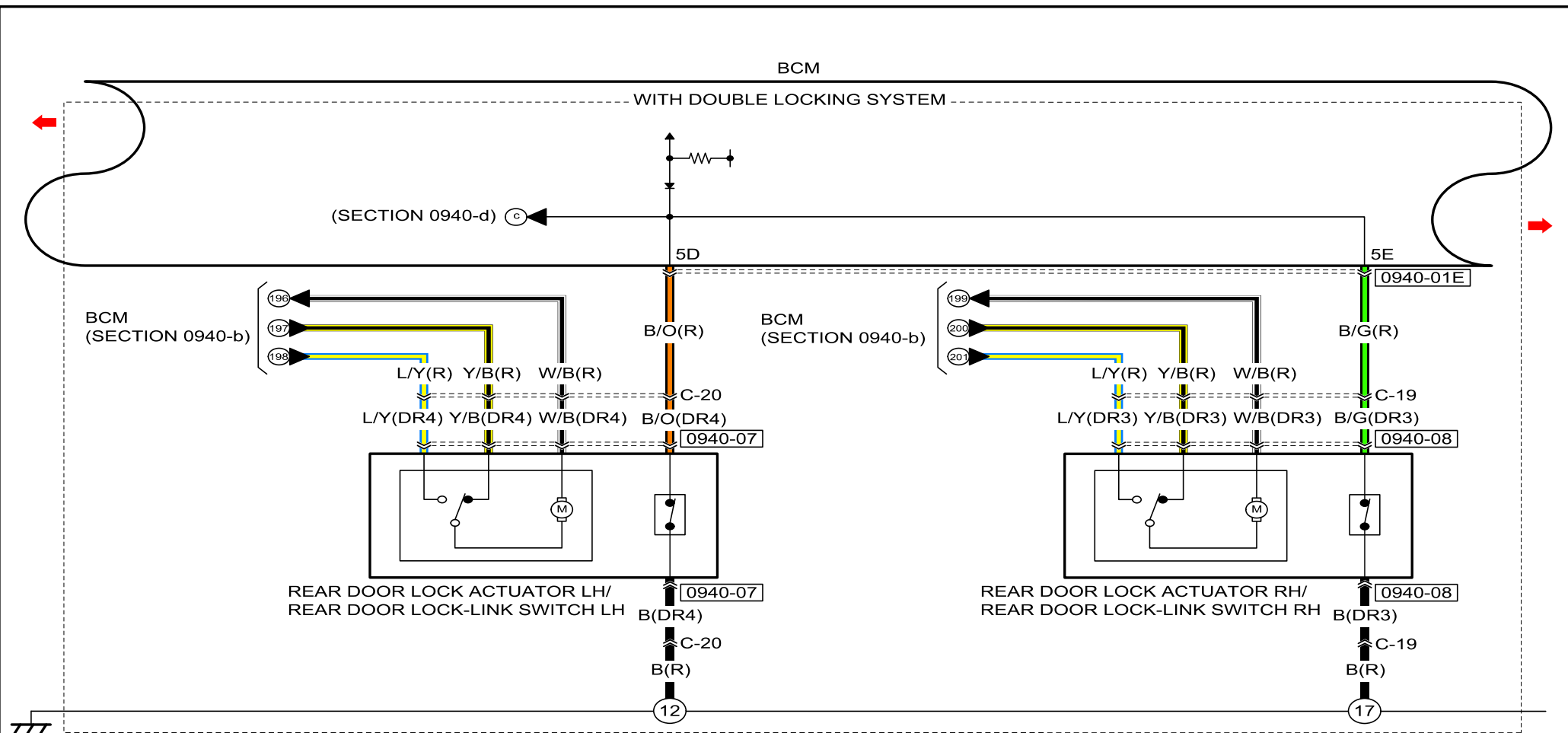
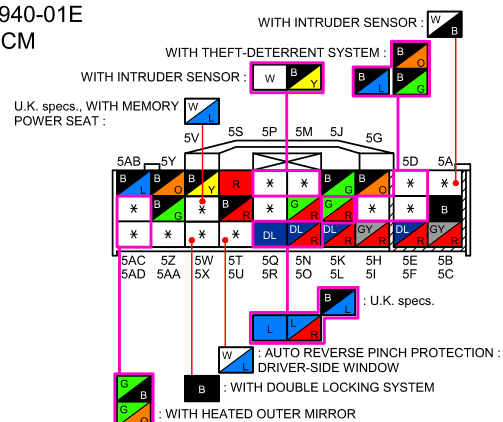
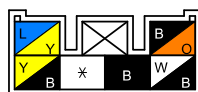
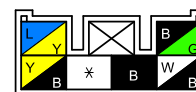

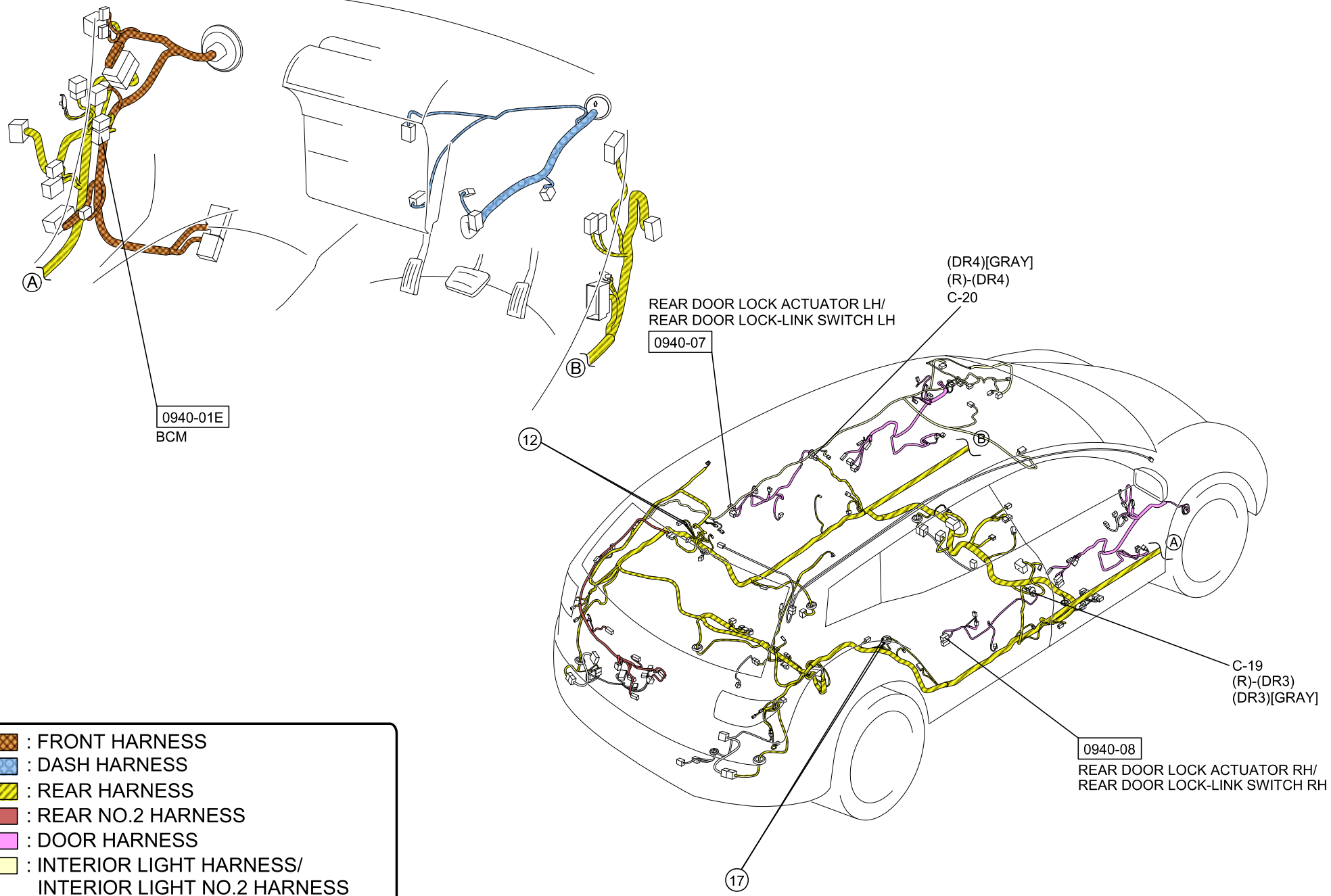
0940-01E
BCM

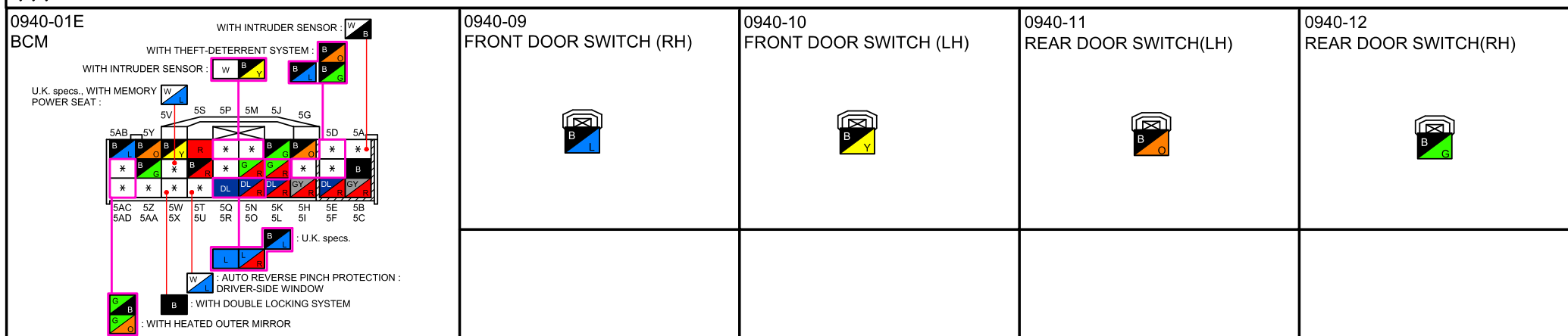
0940-07
REAR DOOR LOCK ACTUATOR LH / REAR DOOR LOCK-LINK SWITCH LH

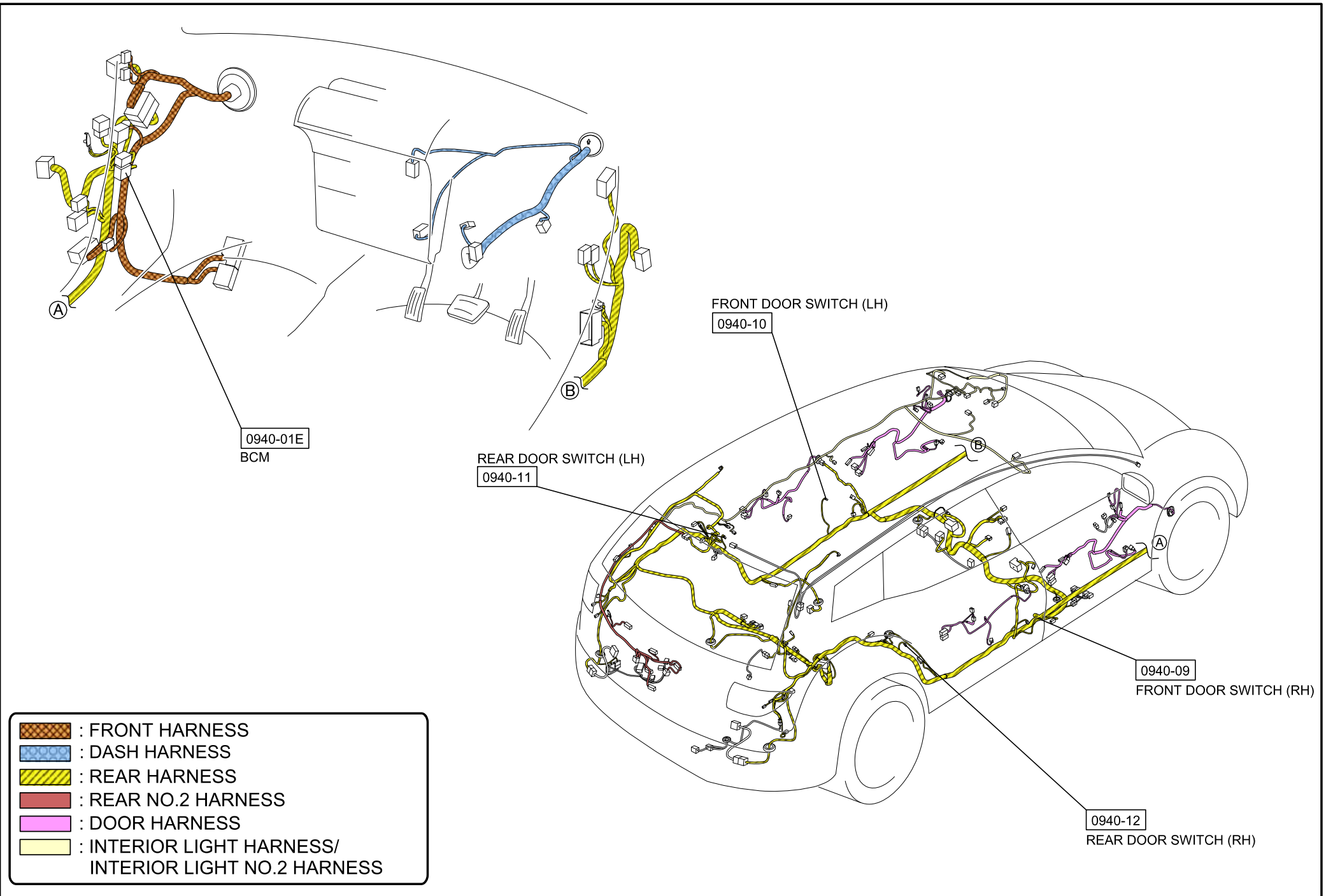
0940-08
REAR DOOR LOCK ACTUATOR RH / REAR DOOR LOCK-LINK SWITCH RH

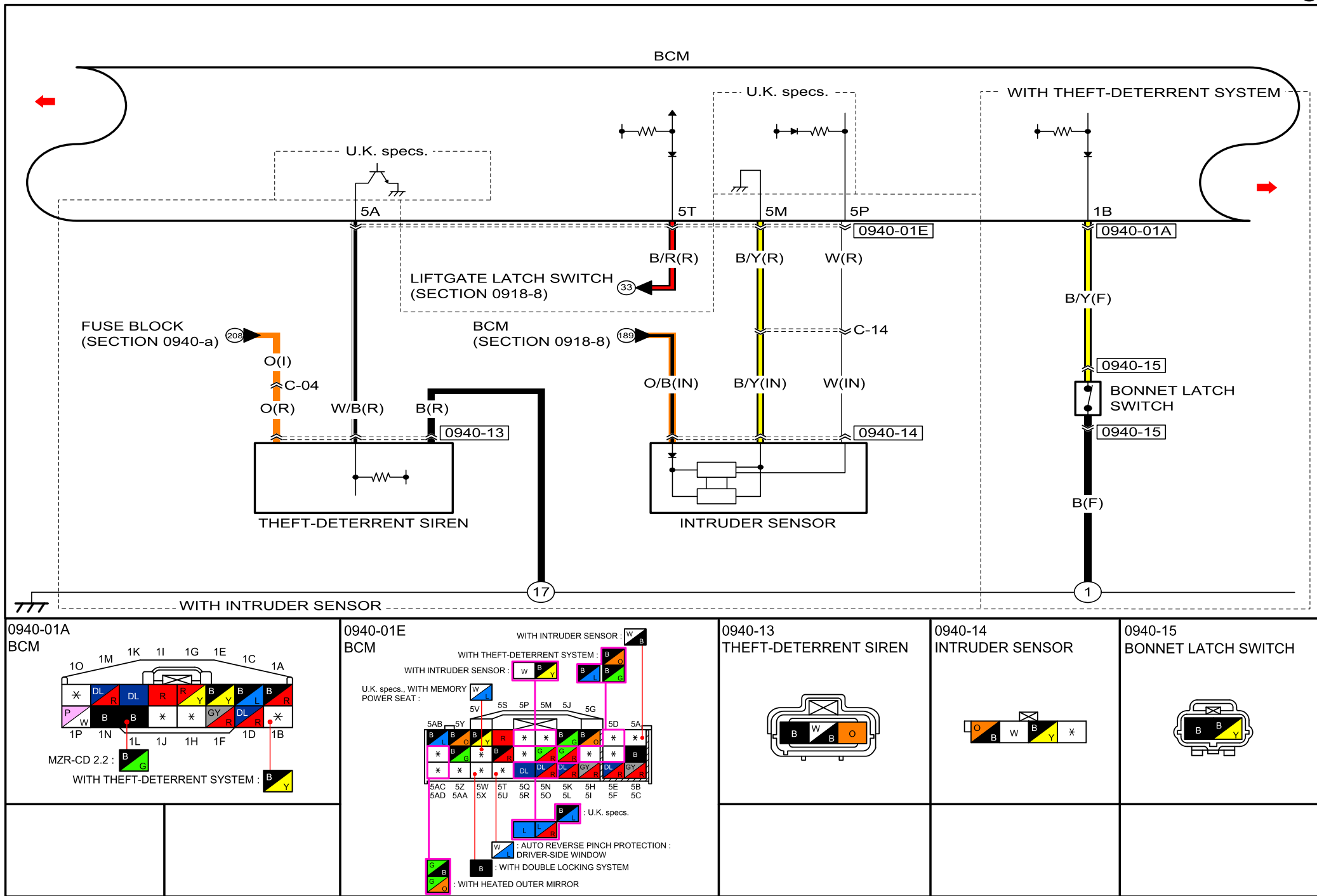

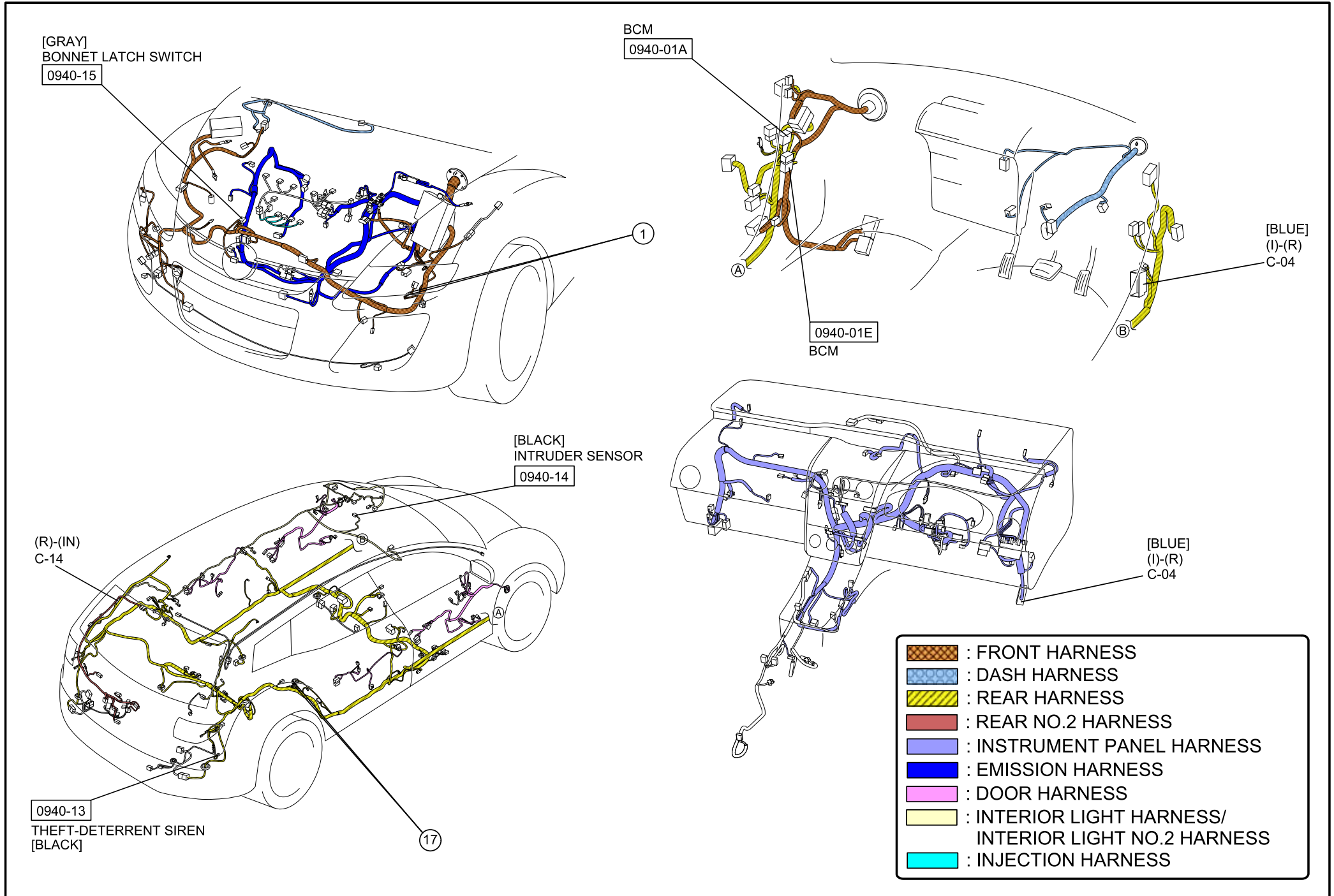







#11 : EXCEPT MZR-CD 2.2/WITHOUT HEADLIGHT CLEANER

BCM

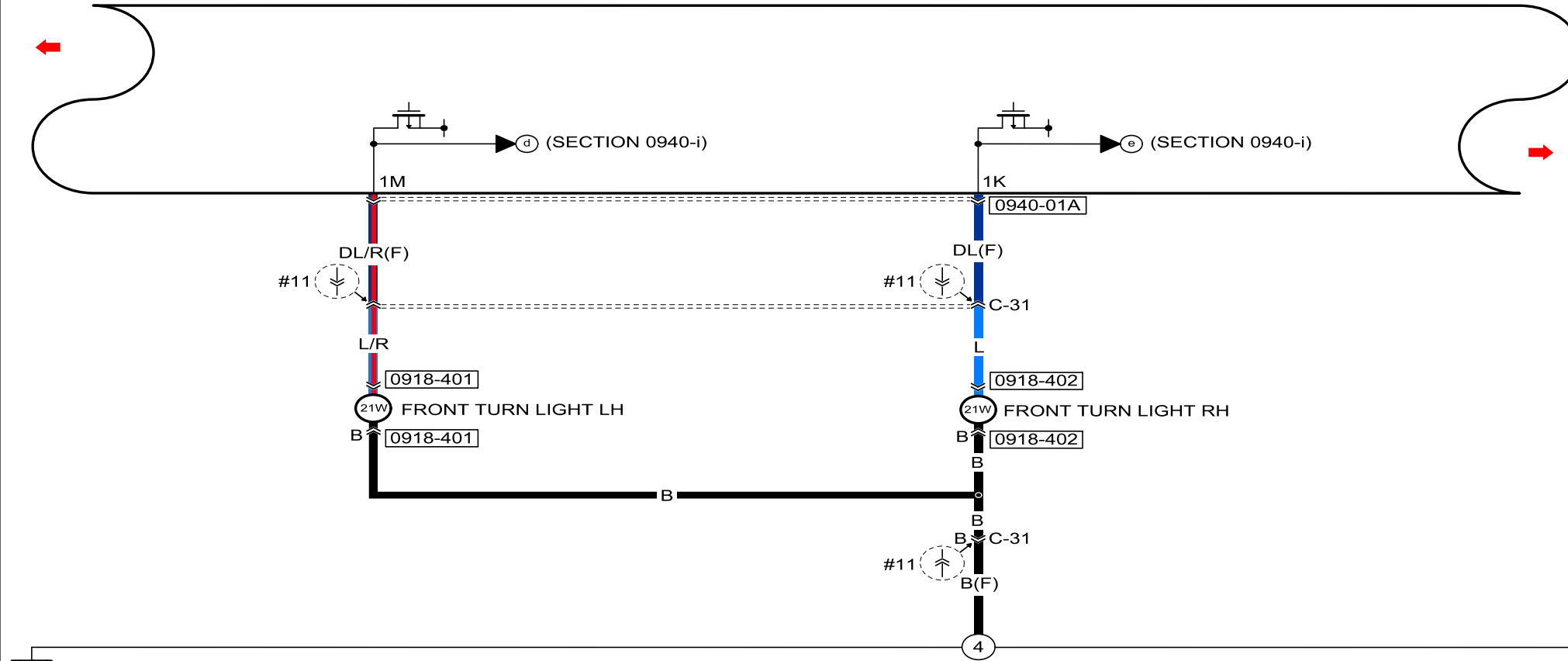

0940-01A
BCM

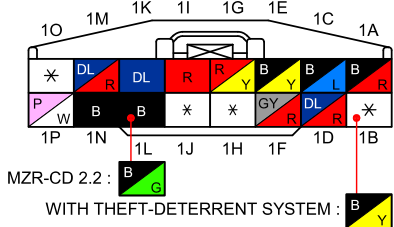

MZR-CD 2.2 :

WITH THEFT-DETERRENT SYSTEM :

0918-401
PARKING LIGHT LH/
FRONT TURN LIGHT LH

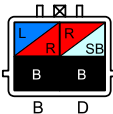

0918-402
PARKING LIGHT RH/
FRONT TURN LIGHT RH

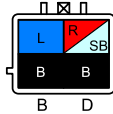

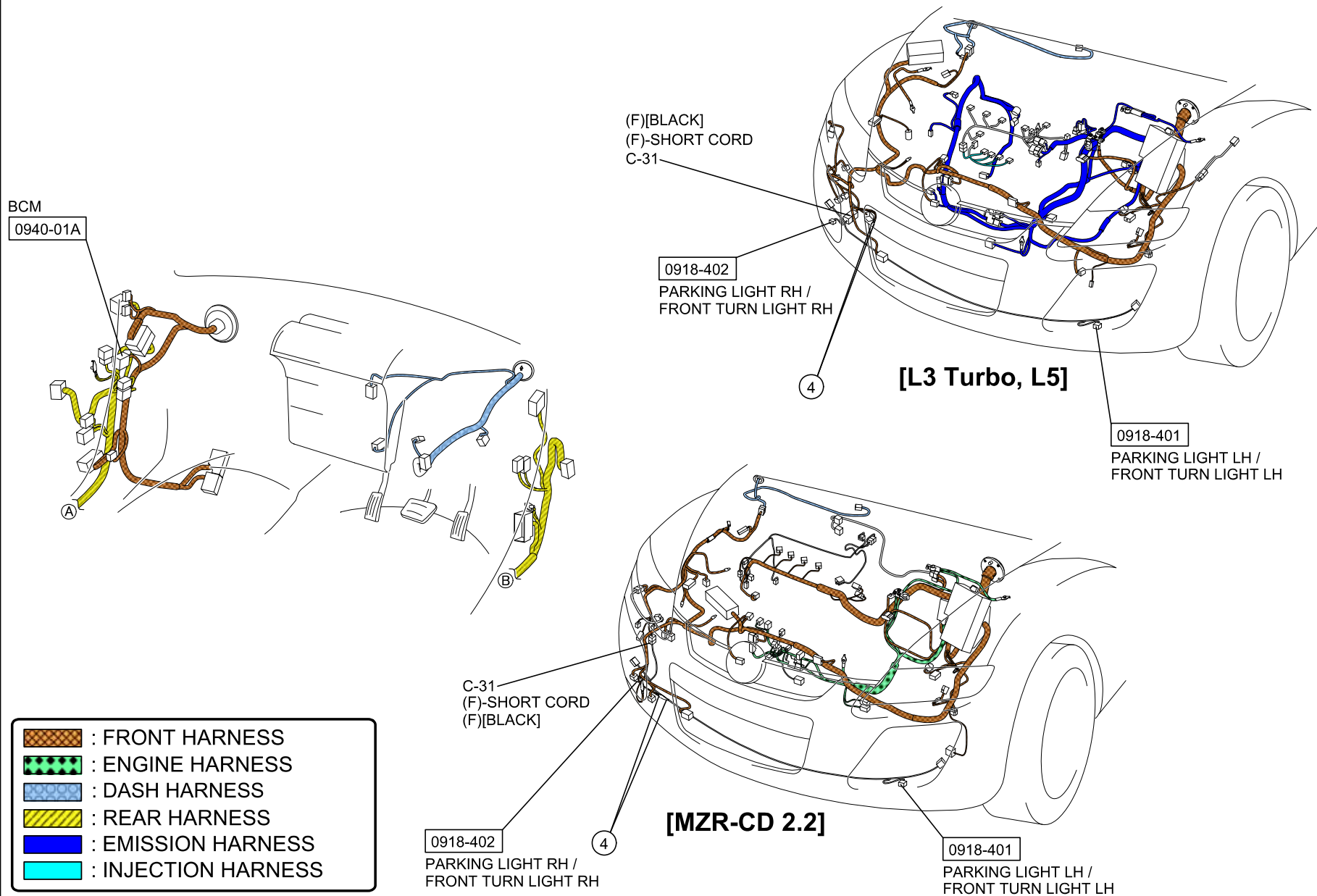

&6 : U.K. specs.
 &20 : WITH REAR VEHICLE MONITORING SYSTEM
 @20 : WITHOUT REAR VEHICLE MONITORING SYSTEM

BCM

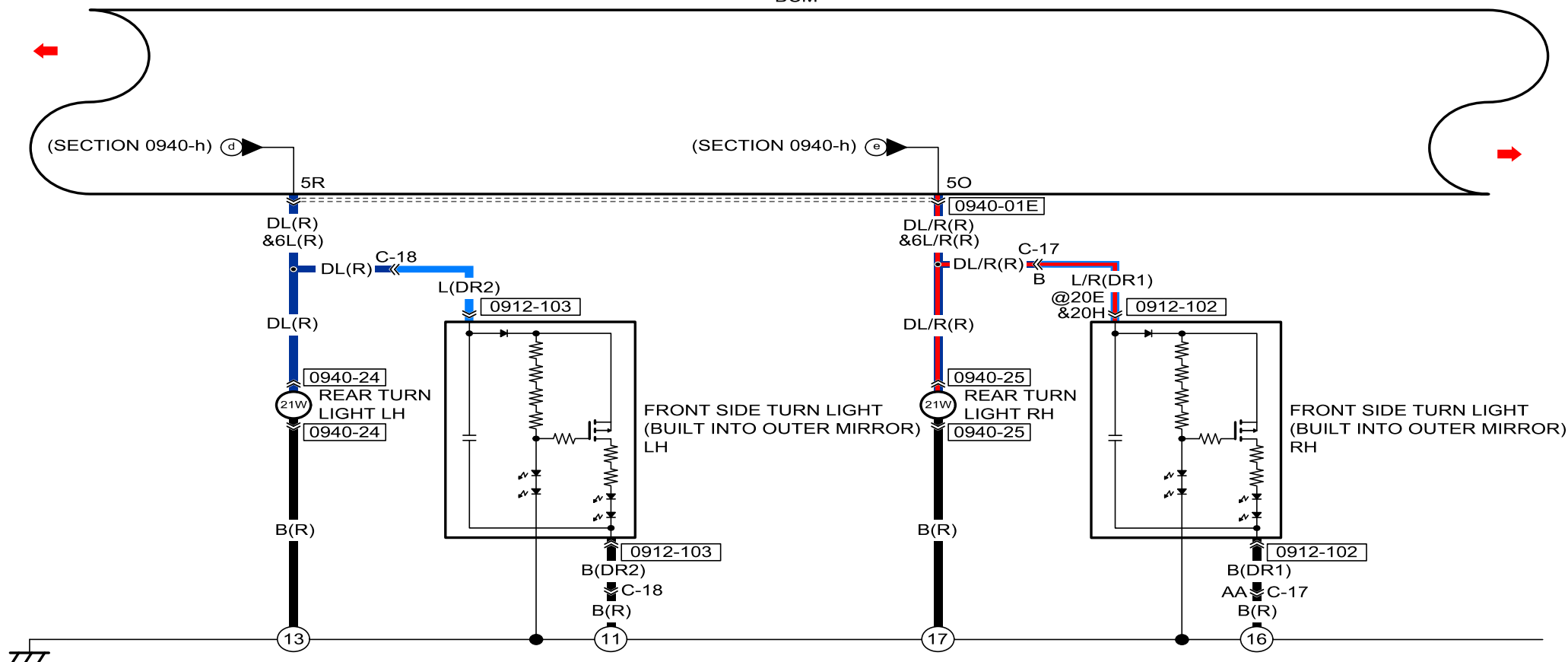

0940-01E
BCM

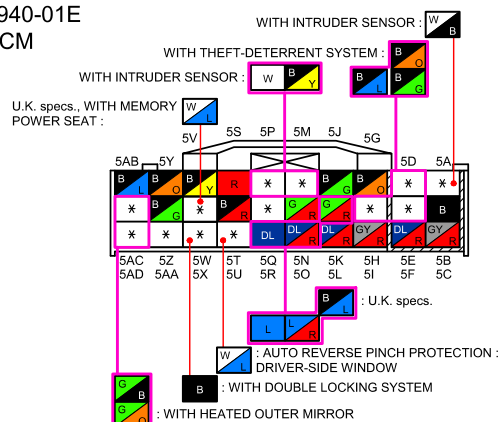

0940-24
REAR TURN LIGHT LH

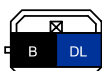

0940-25
REAR TURN LIGHT RH

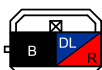

0912-102
HEATED OUTER MIRROR RH/
POWER OUTER MIRROR RH/
RETRACTABLE OUTER MIRROR RH/
RVM WARNING INDICATOR (RH)/
FRONT SIDE TURN LIGHT
(BUILT INTO OUTER MIRROR) RH

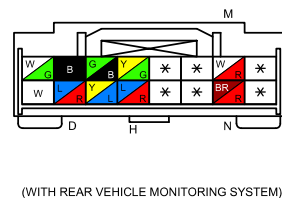
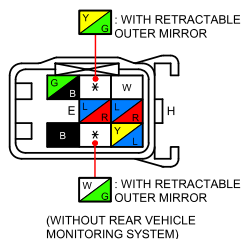

0912-103
HEATED OUTER MIRROR LH/
POWER OUTER MIRROR LH/
RETRACTABLE OUTER MIRROR LH/
RVM WARNING INDICATOR (LH)/
FRONT SIDE TURN LIGHT
(BUILT INTO OUTER MIRROR) LH

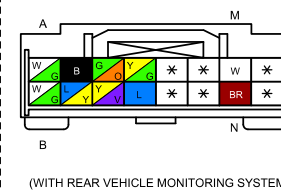
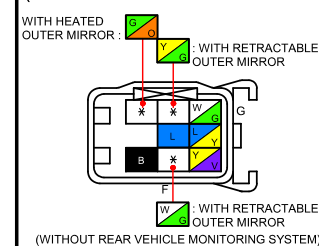

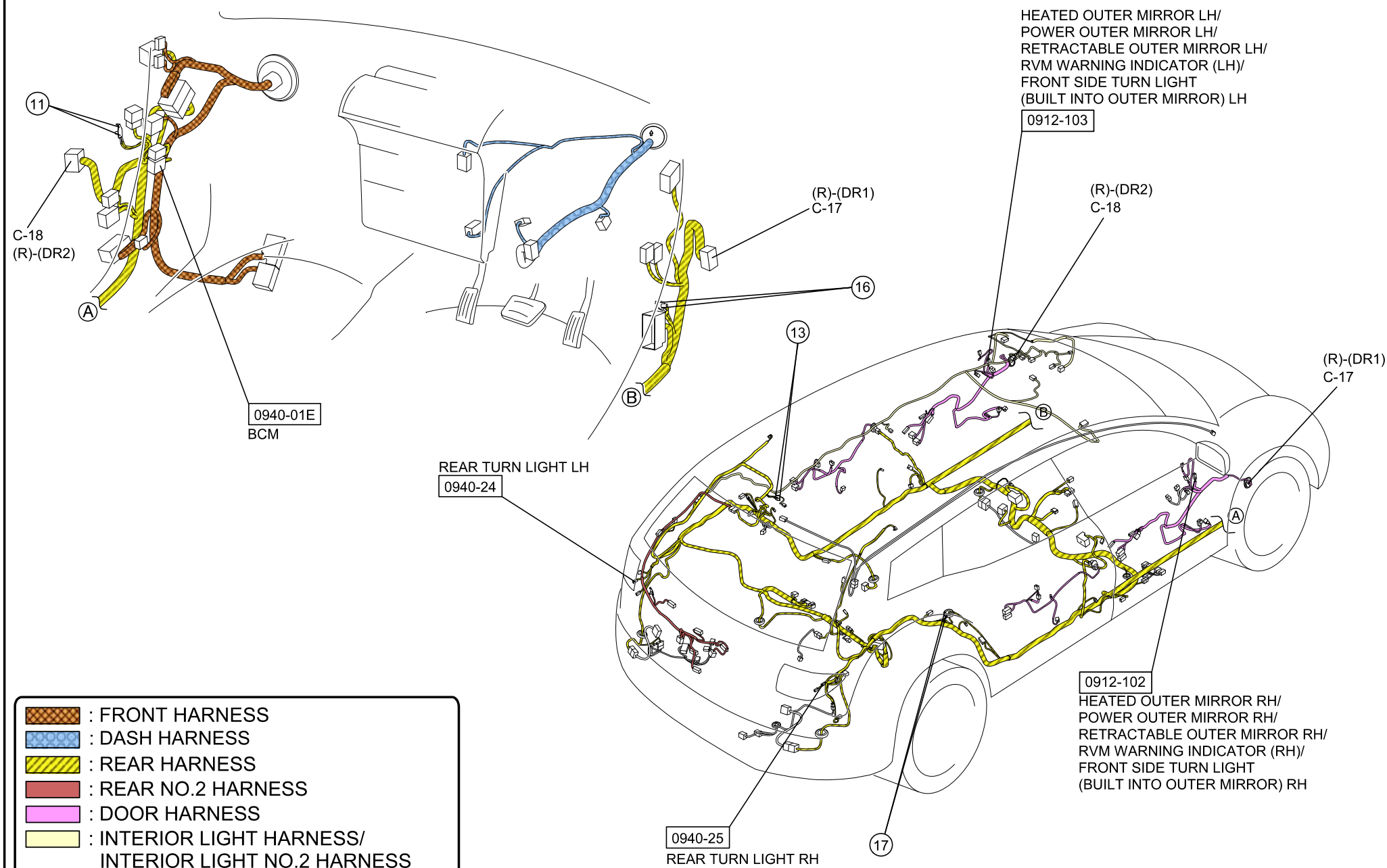

@ : EXCEPT U.K. specs.
 @5 : LIGHT SWITCH RIGHT SIDE

#1 : WITHOUT AUTO LIGHT SYSTEM
 #2 : WITH AUTO LIGHT SYSTEM
 #7 : MZR-CD 2.2

BCM

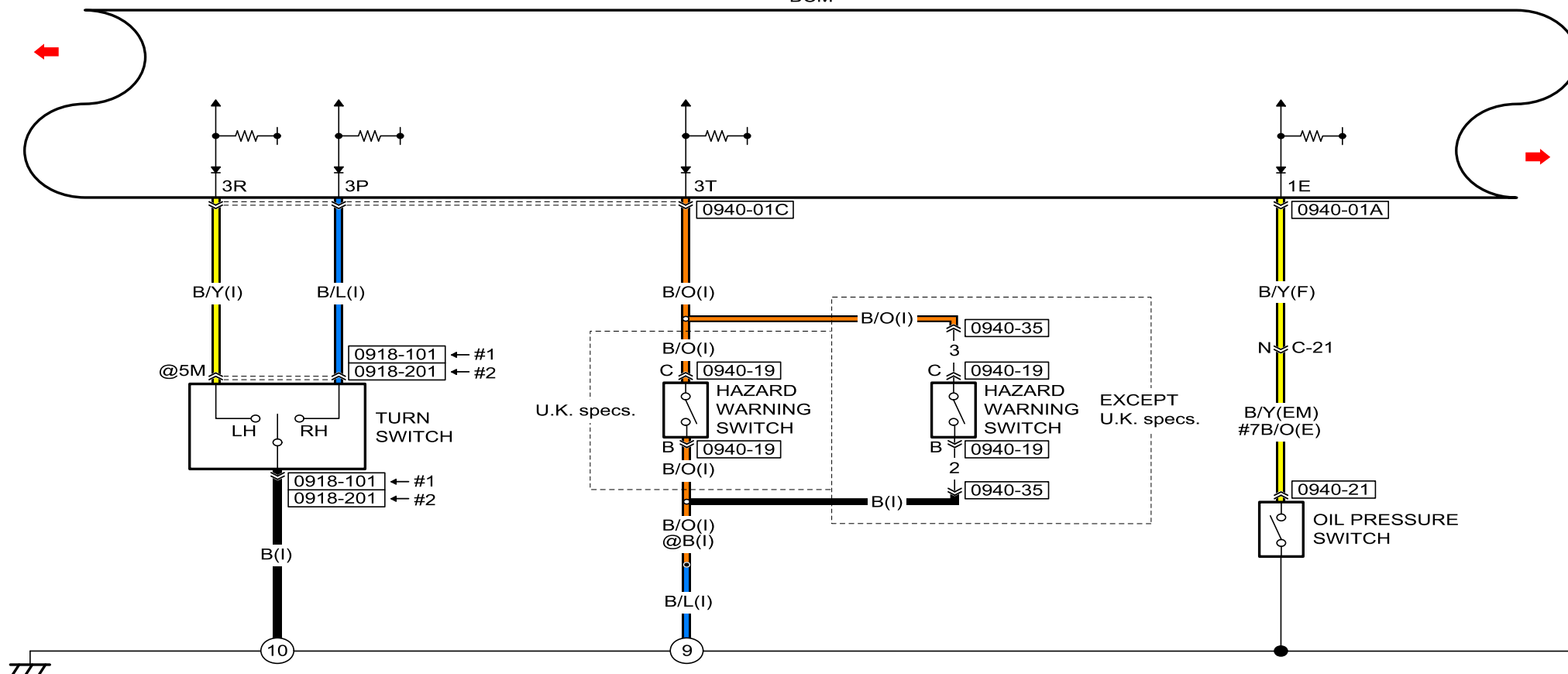
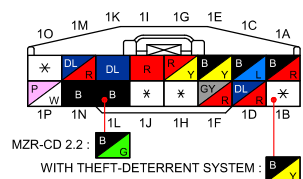
0940-01A
BCM0940-01C
BCM

WITHOUT ADVANCED KEYLESS ENTRY AND START SYSTEM/
 EXCEPT U.K. specs. :

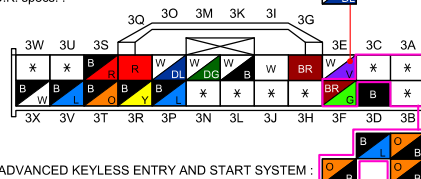

WITHOUT ADVANCED KEYLESS ENTRY AND START SYSTEM :

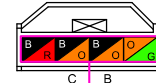
0940-19
HAZARD WARNING
SWITCH ILLUMINATION/
HAZARD WARNING SWITCH

WIRE COLORS ARE INDICATED BY NUMBERS.
 : EXCEPT U.K. specs.

0940-21
OIL PRESSURE SWITCH

(EXCEPT MZR-CD 2.2) (MZR-CD 2.2)

0940-35
INSTRUMENT PANEL HARNESS-SHORT CORD

WIRE COLORS ARE INDICATED BY NUMBERS.

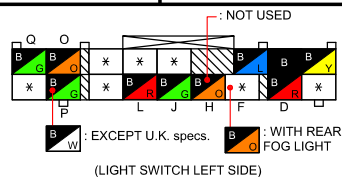
0918-101
HEADLIGHT SWITCH/
FRONT AND REAR
FOG LIGHT SWITCH/
TURN SWITCH

(LIGHT SWITCH LEFT SIDE)

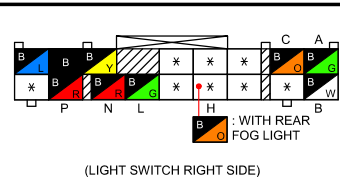

(LIGHT SWITCH RIGHT SIDE)

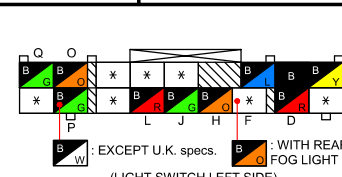
0918-201
HEADLIGHT SWITCH/
FRONT AND REAR
FOG LIGHT SWITCH/
TURN SWITCH

(LIGHT SWITCH LEFT SIDE)

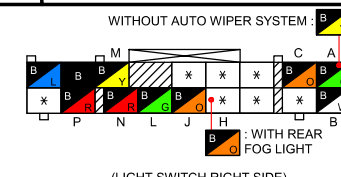

(LIGHT SWITCH RIGHT SIDE)

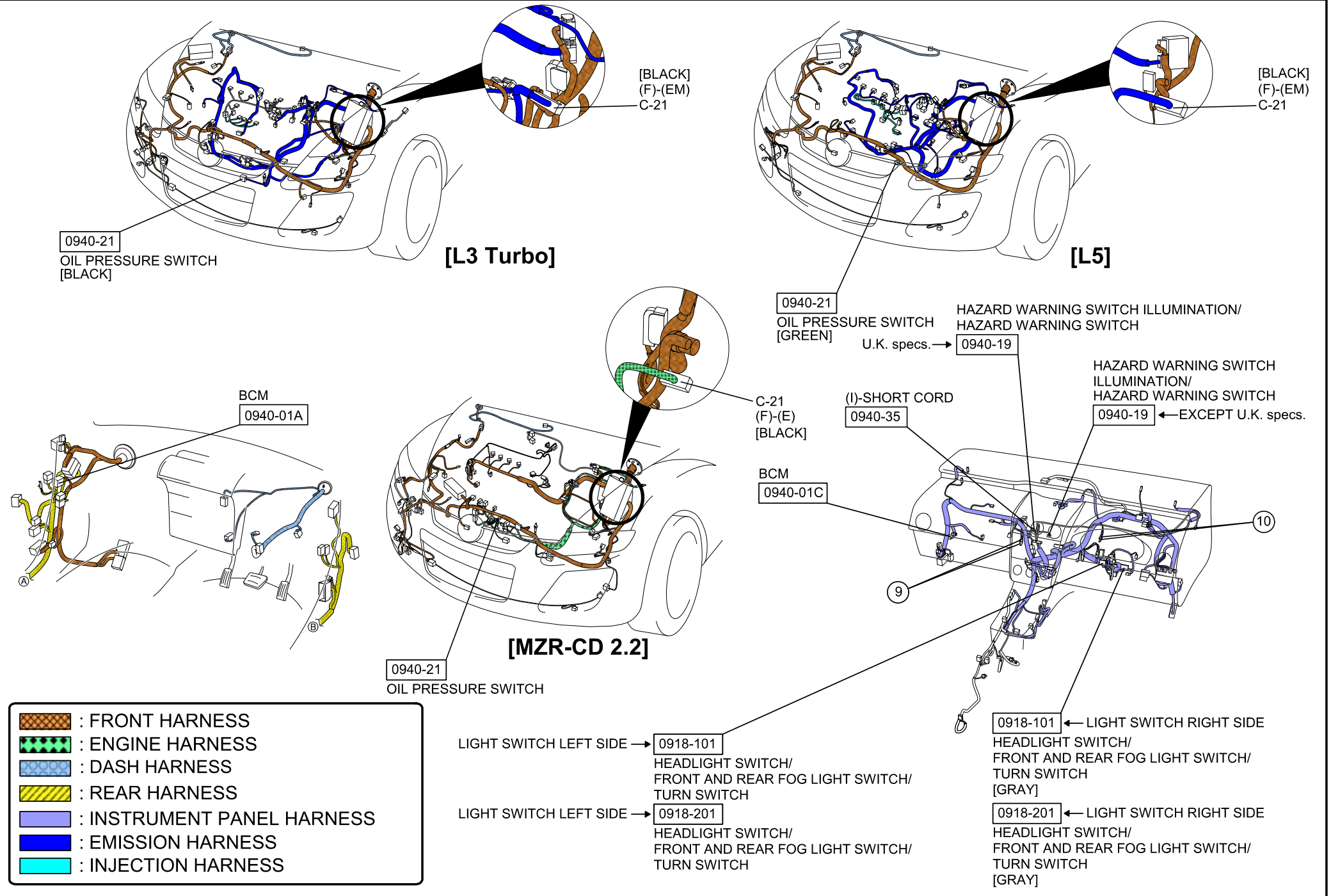

@8 : ATX
#7 : MZR-CD 2.2

BCM

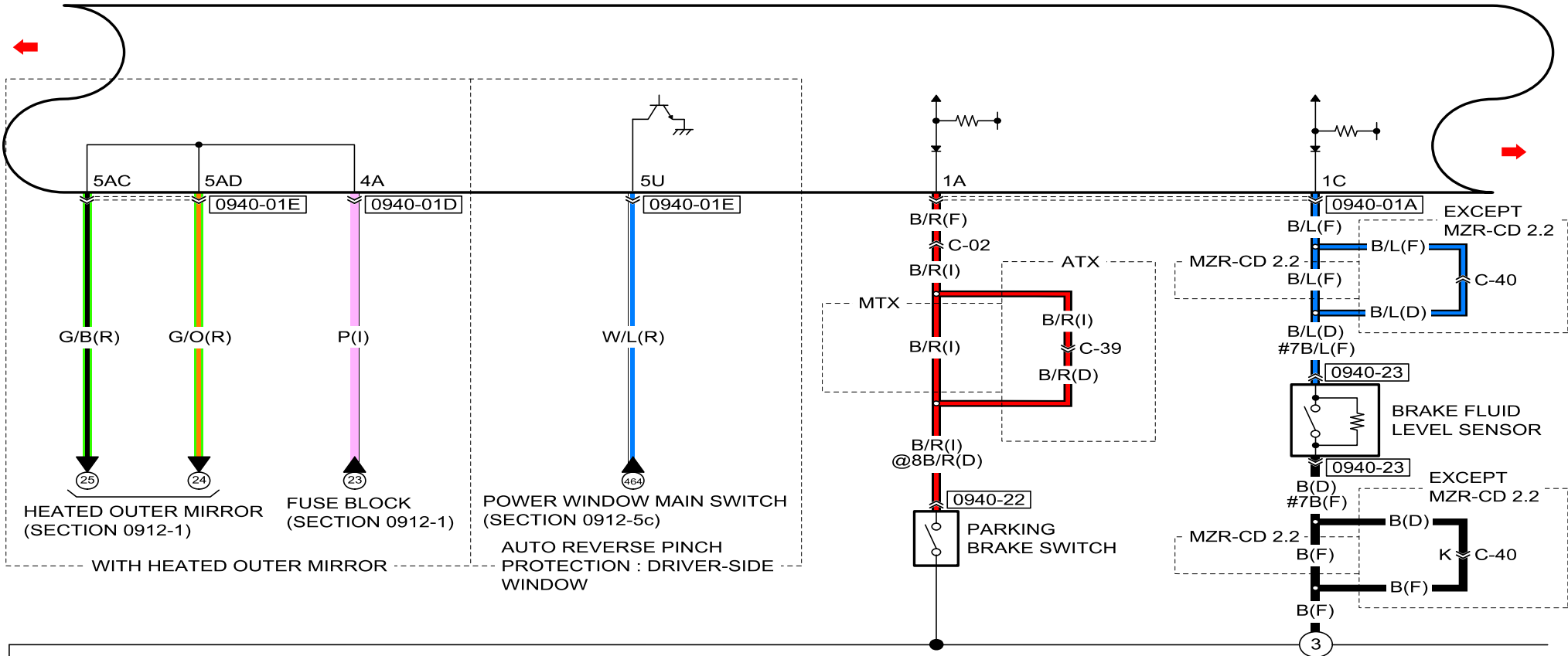

0940-01A
BCM

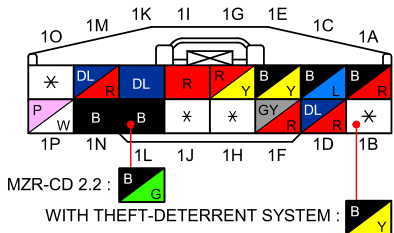

0940-01D
BCM

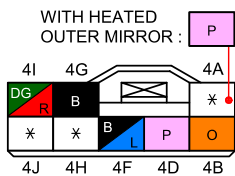

0940-01E
BCM

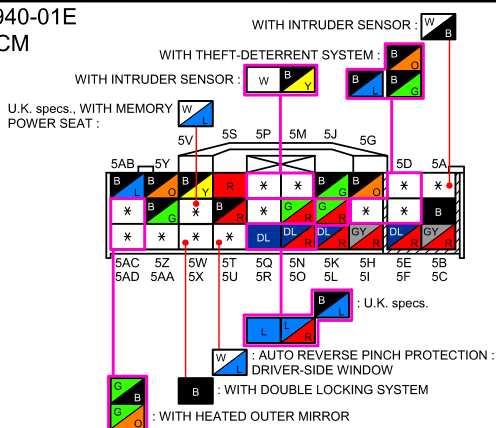

0940-22
PARKING BRAKE SWITCH



0940-23
BRAKE FLUID LEVEL SENSOR



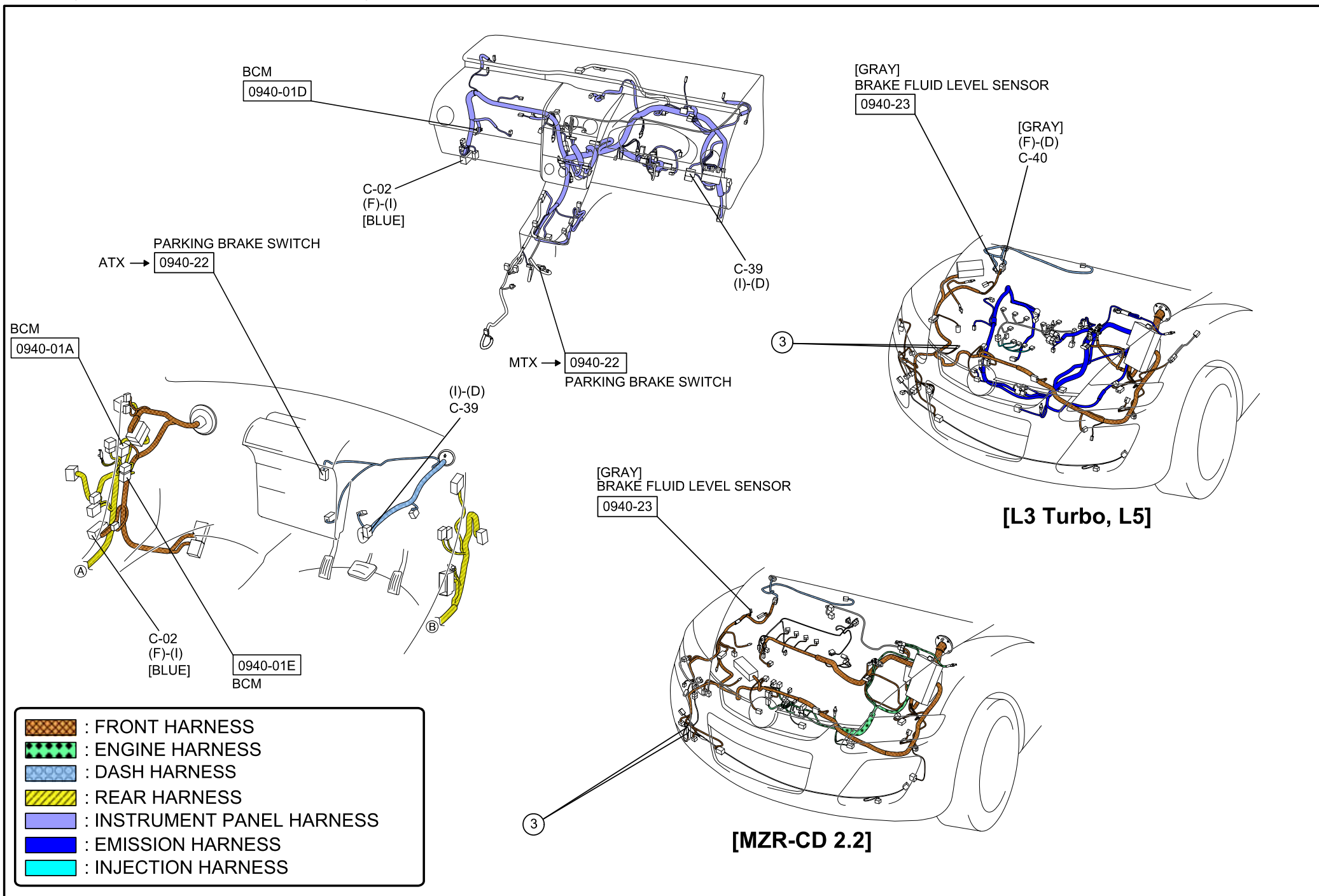

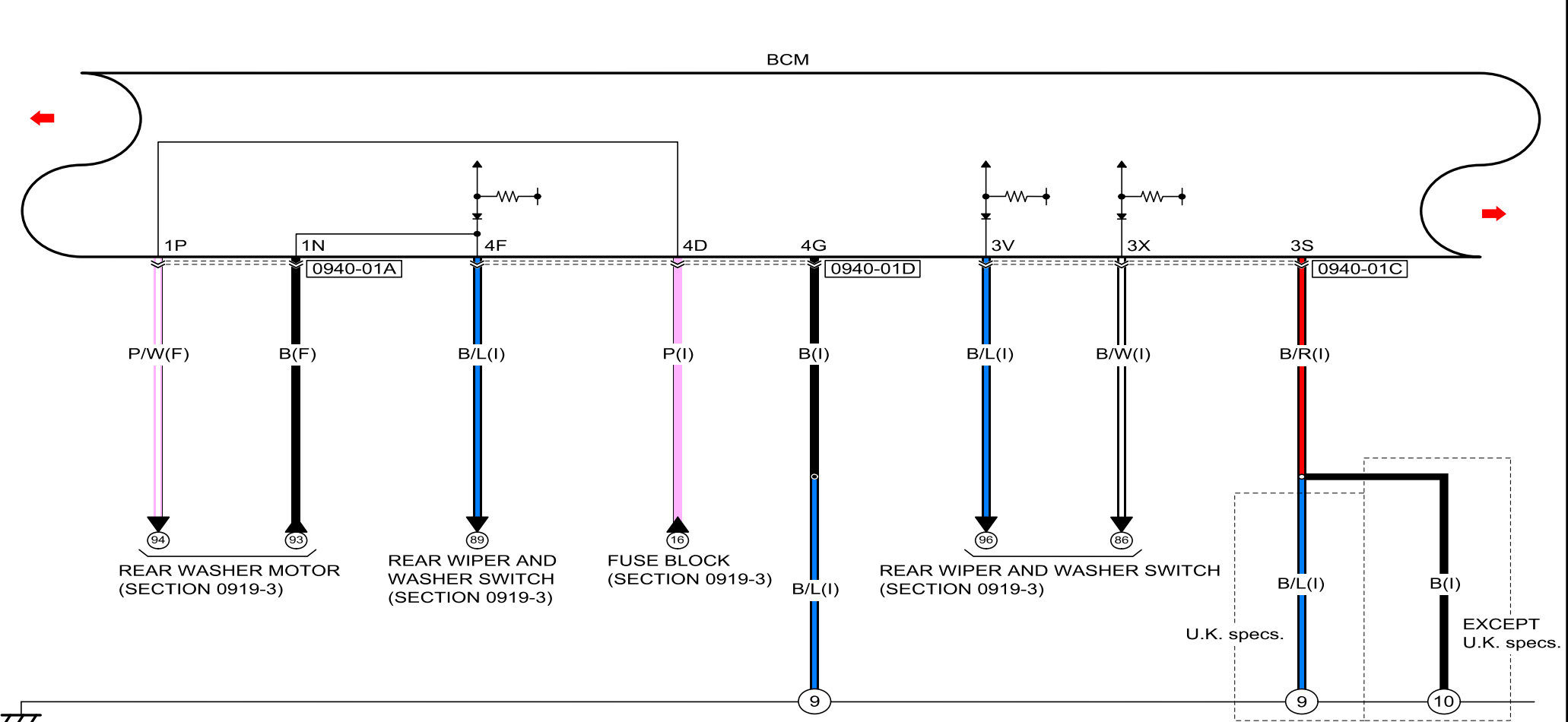

0940-01A
BCM

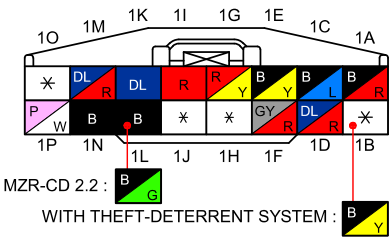

0940-01C
BCM

WITHOUT ADVANCED KEYLESS ENTRY AND START SYSTEM/
EXCEPT U.K. specs. :

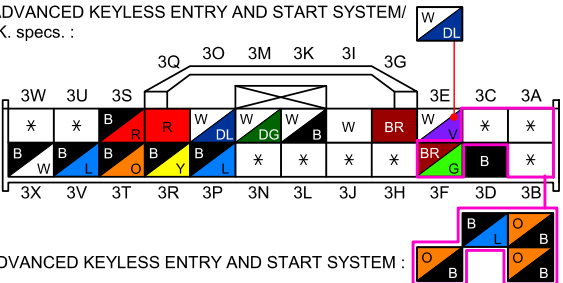

0940-01D
BCM

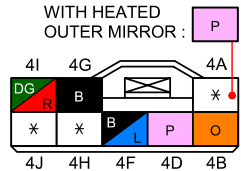

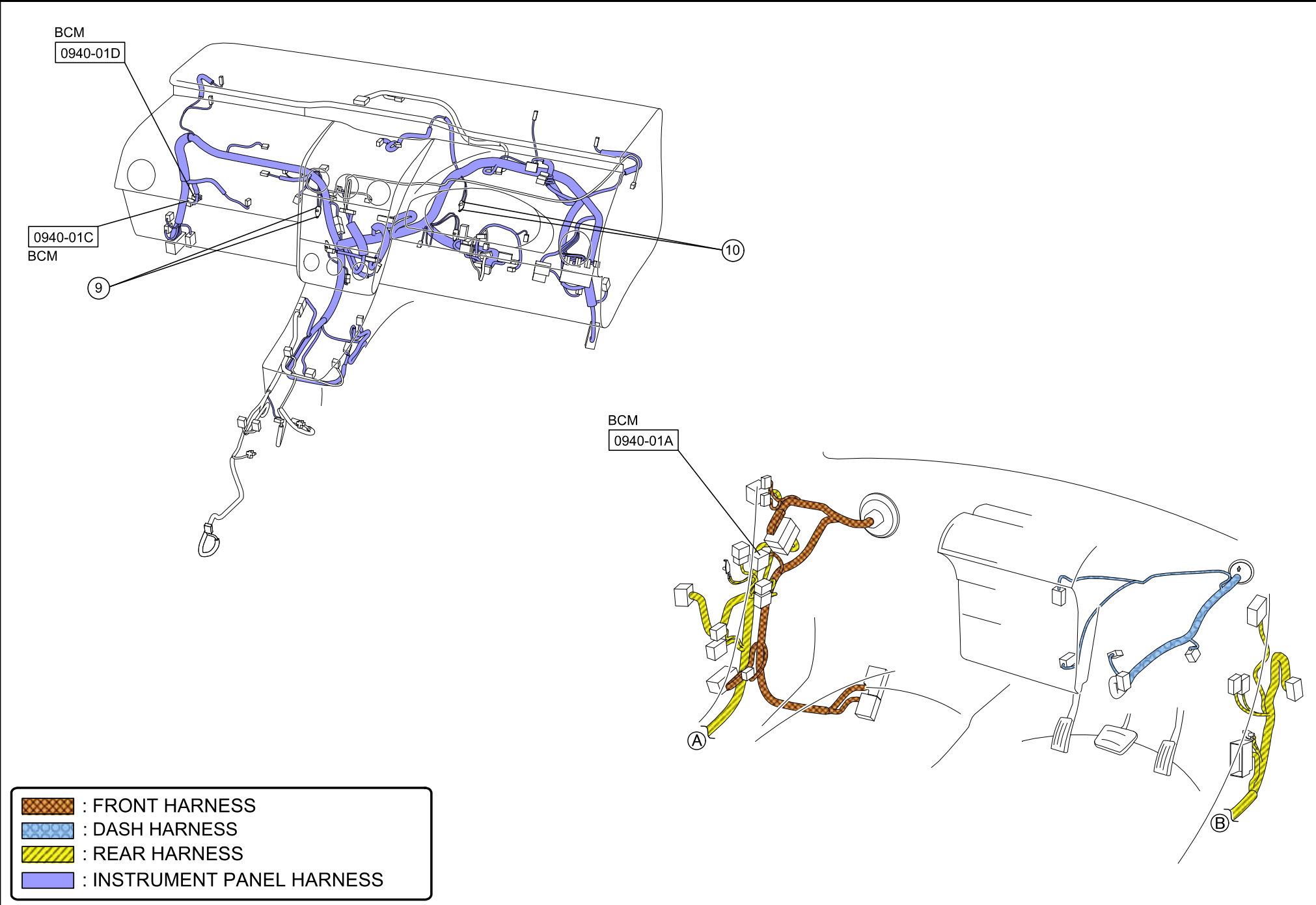

&3 : WITHOUT ADVANCED KEYLESS ENTRY AND START SYSTEM/EXCEPT U.K. specs.
#7 : MZR-CD 2.2

BCM

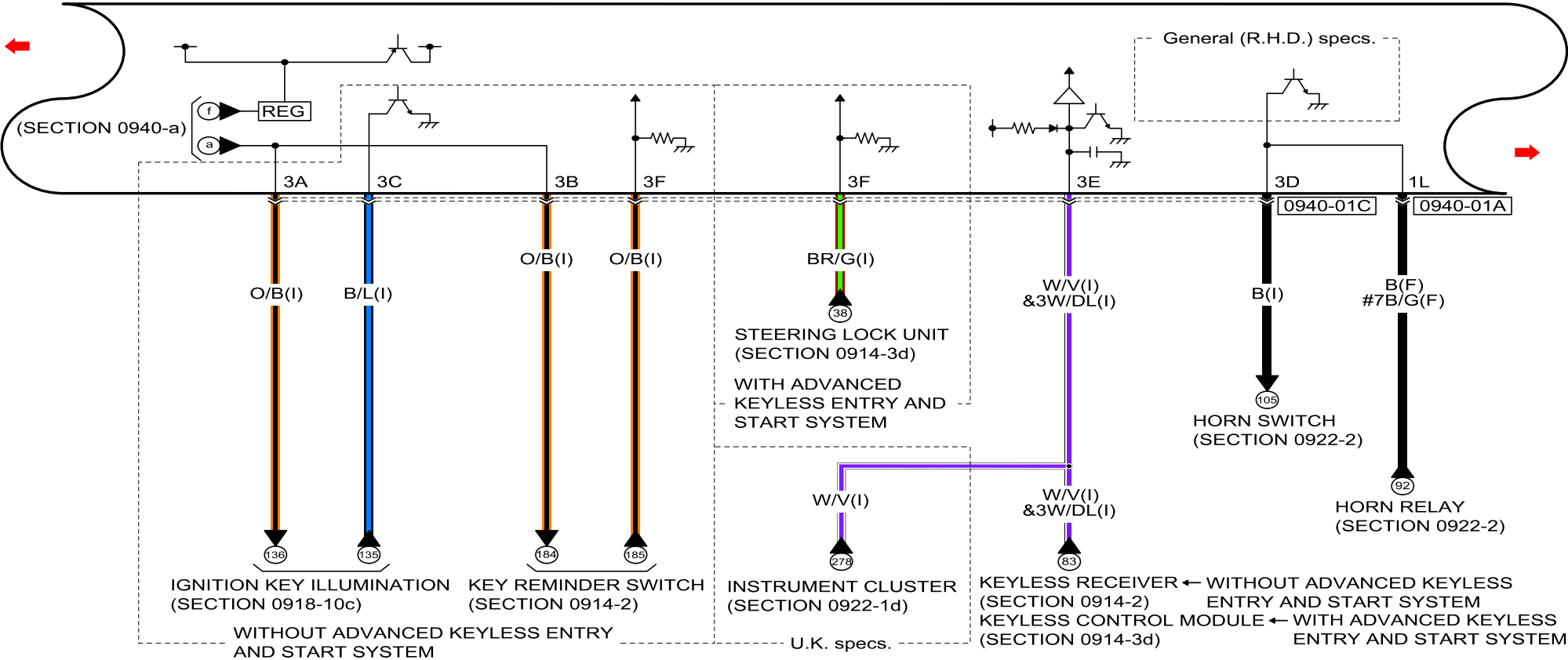

0940-01A
BCM

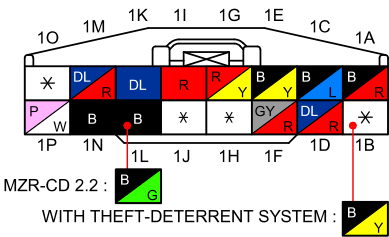



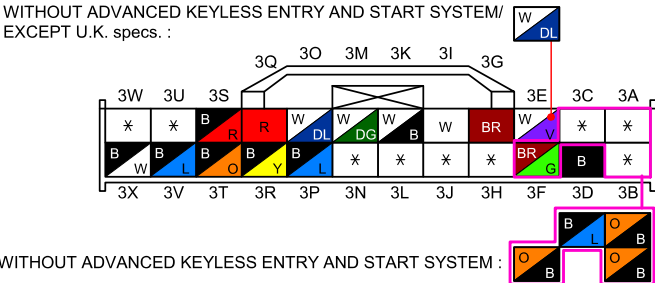

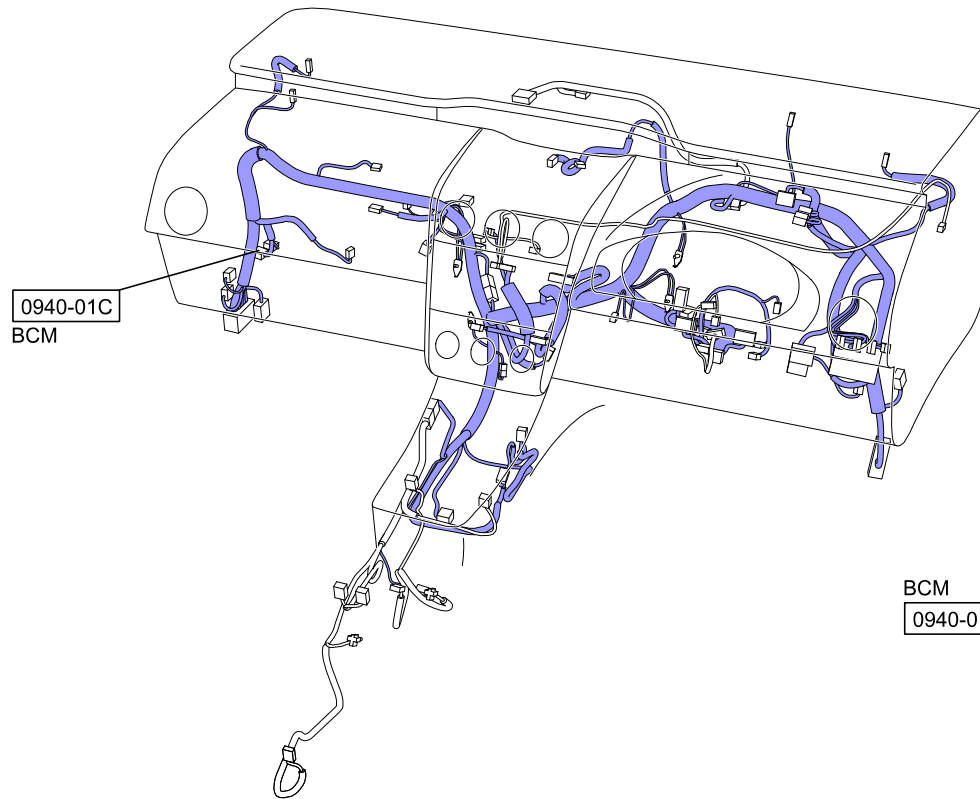
0940-01C
BCM



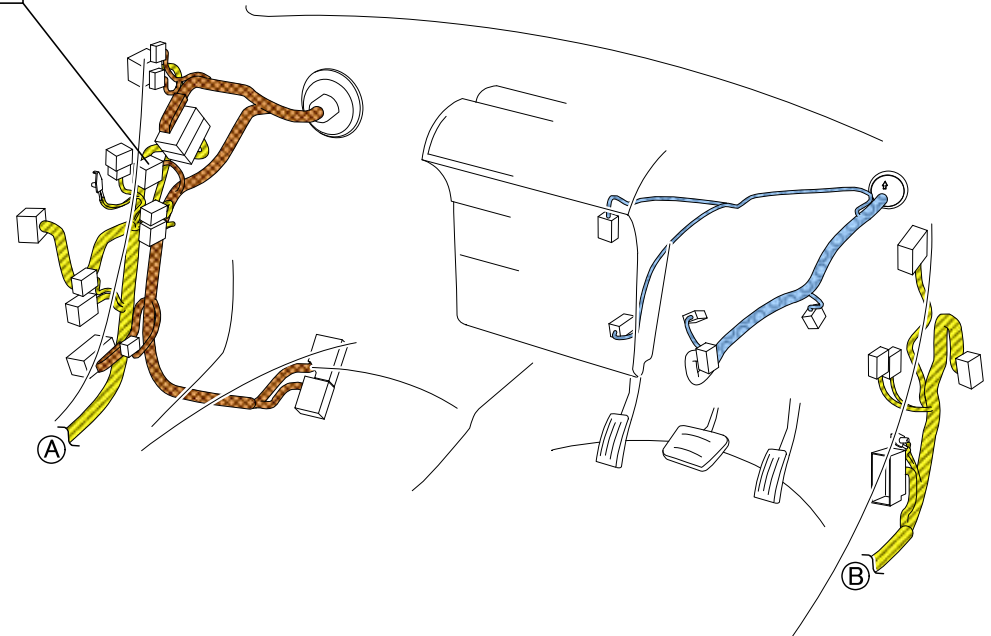

BCM
0940-01A



-  : FRONT HARNESS
-  : DASH HARNESS
-  : REAR HARNESS
-  : INSTRUMENT PANEL HARNESS

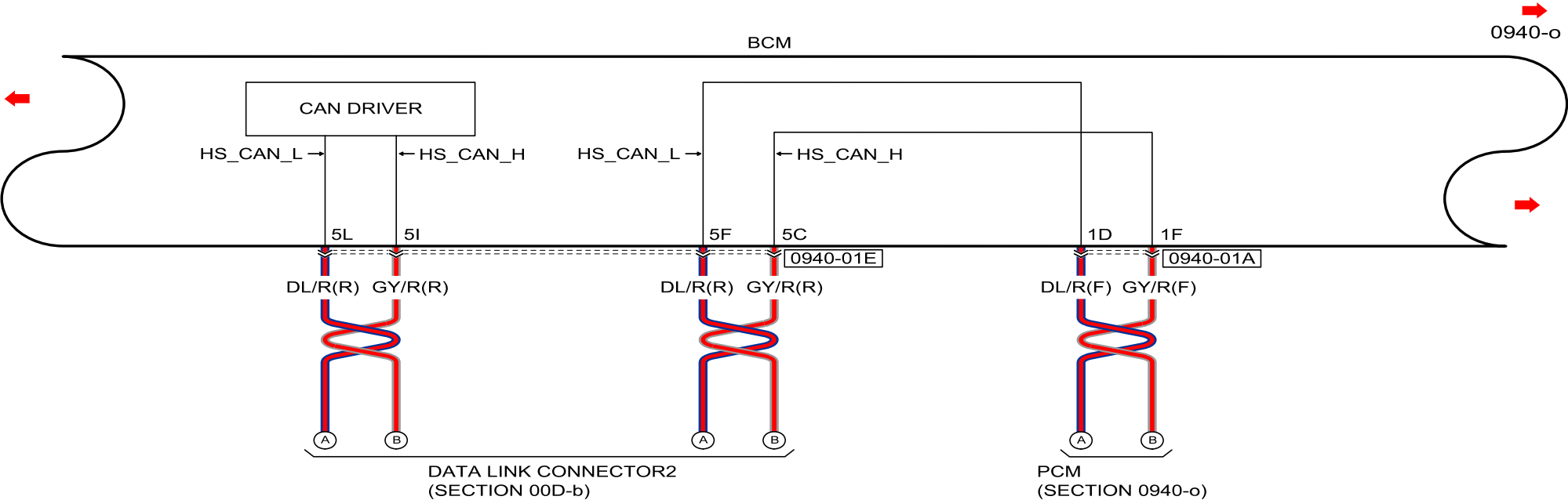

0940-01A
BCM

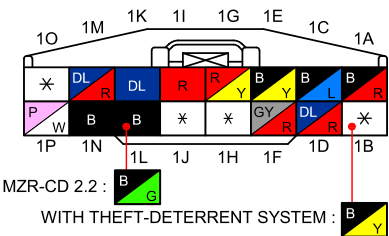

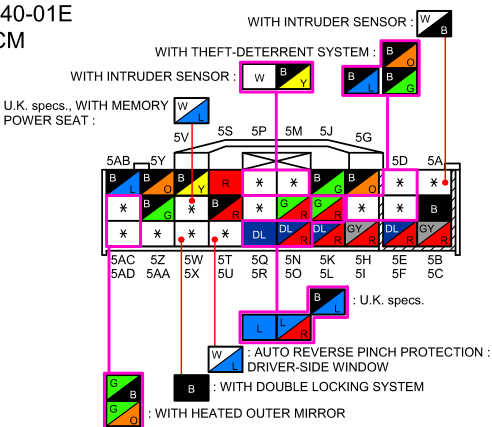

0940-01E
BCM

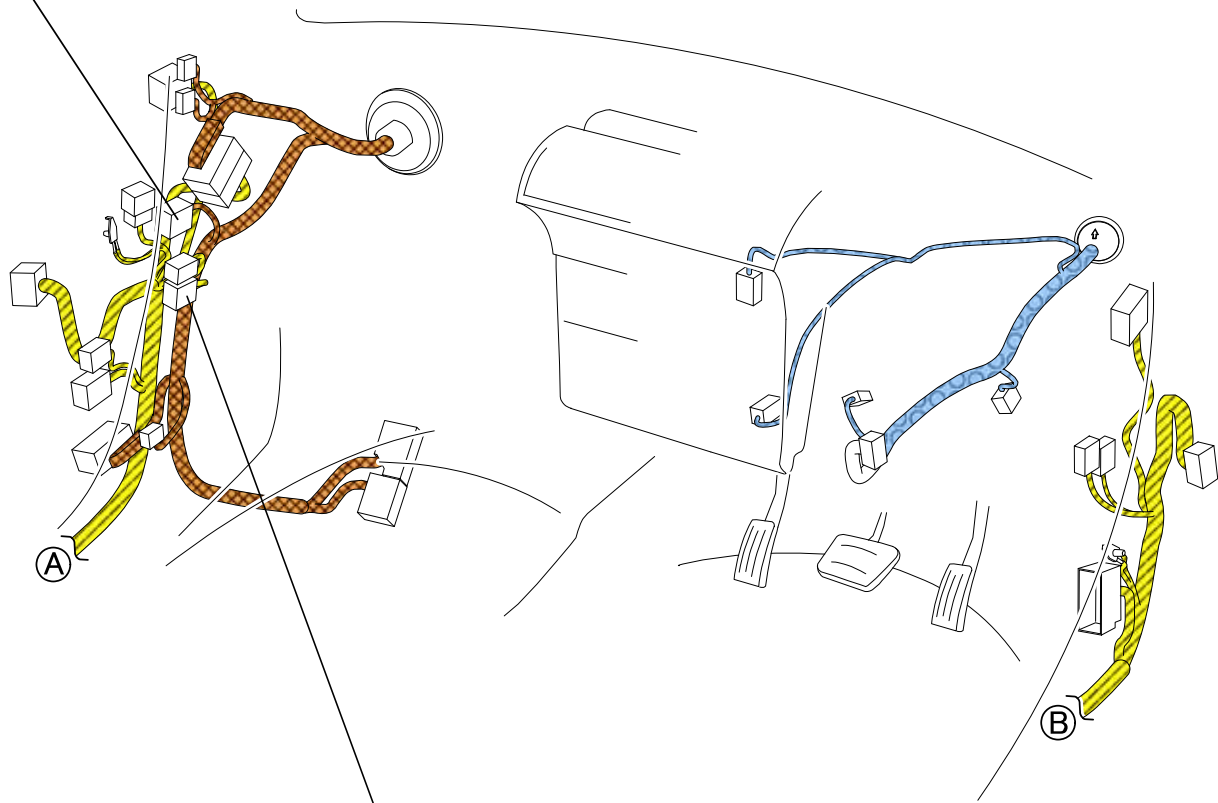

BCM
0940-01A



-  : FRONT HARNESS
-  : DASH HARNESS
-  : REAR HARNESS

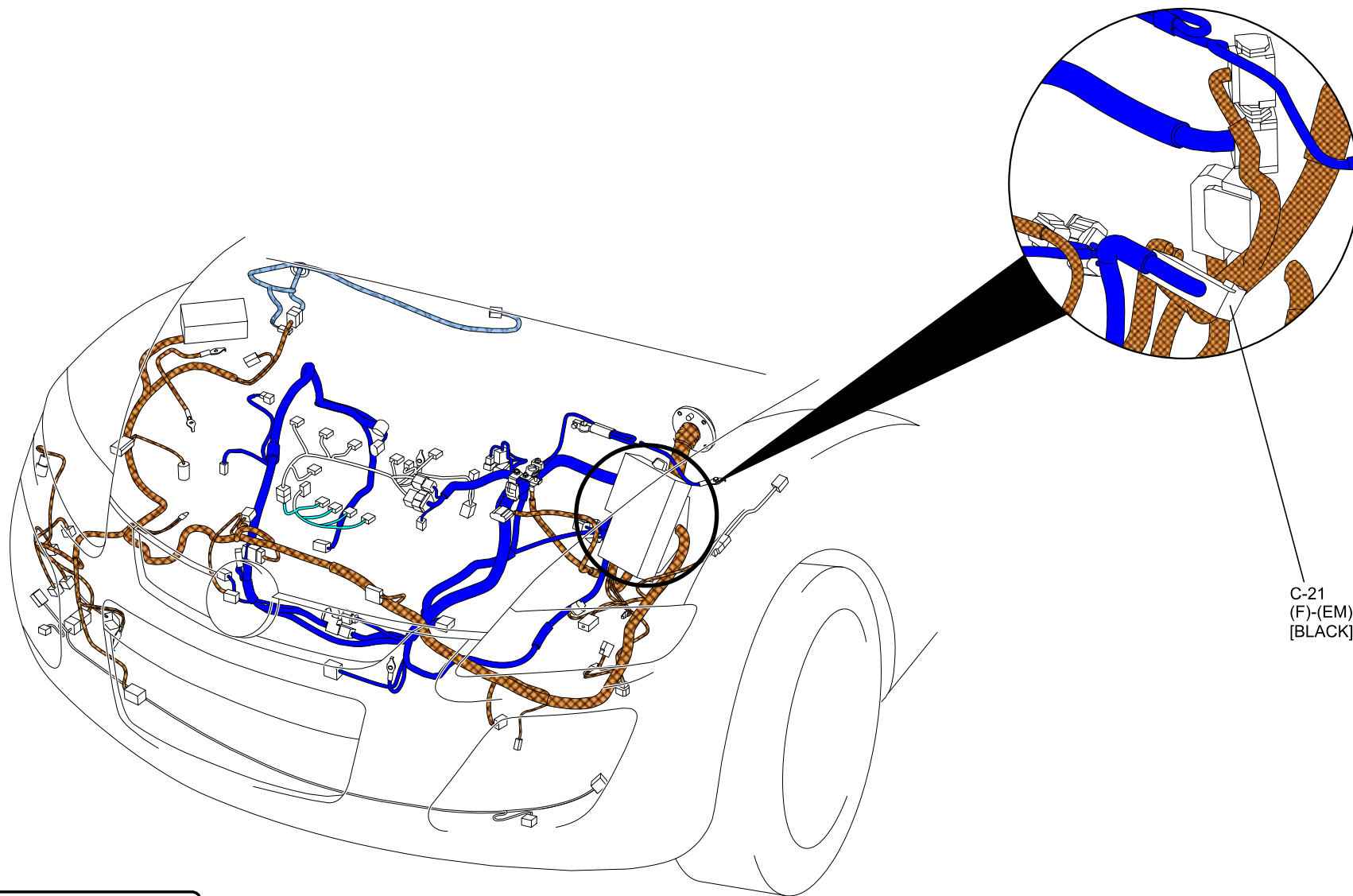

C-21
(F)-(EM)
[BLACK]

- : FRONT HARNESS
- : DASH HARNESS
- : EMISSION HARNESS
- : INJECTION HARNESS

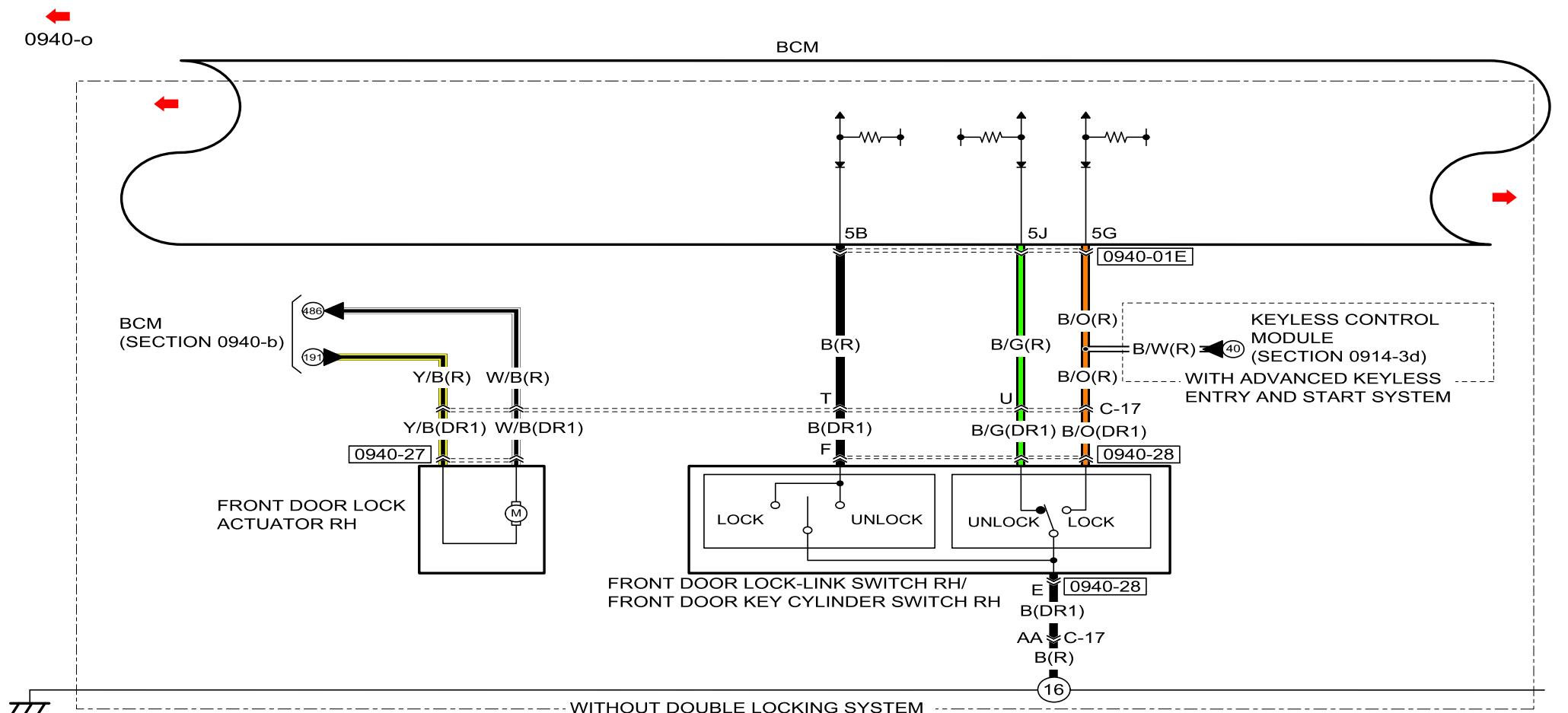

0940-01E
BCM

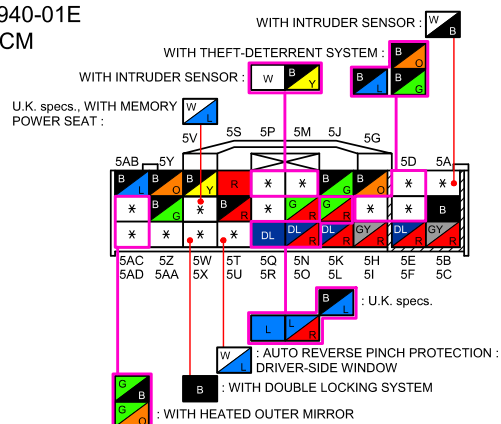

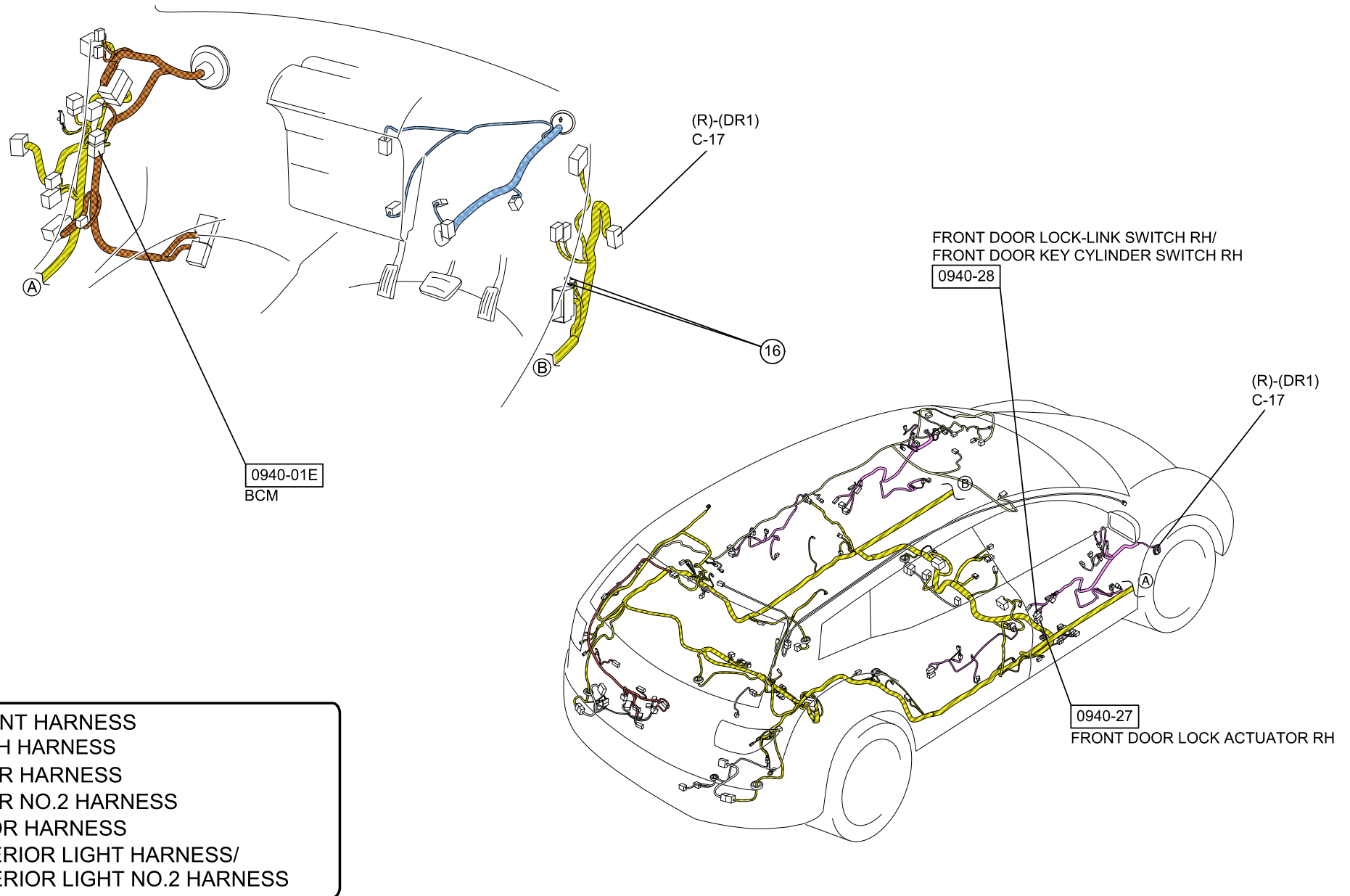

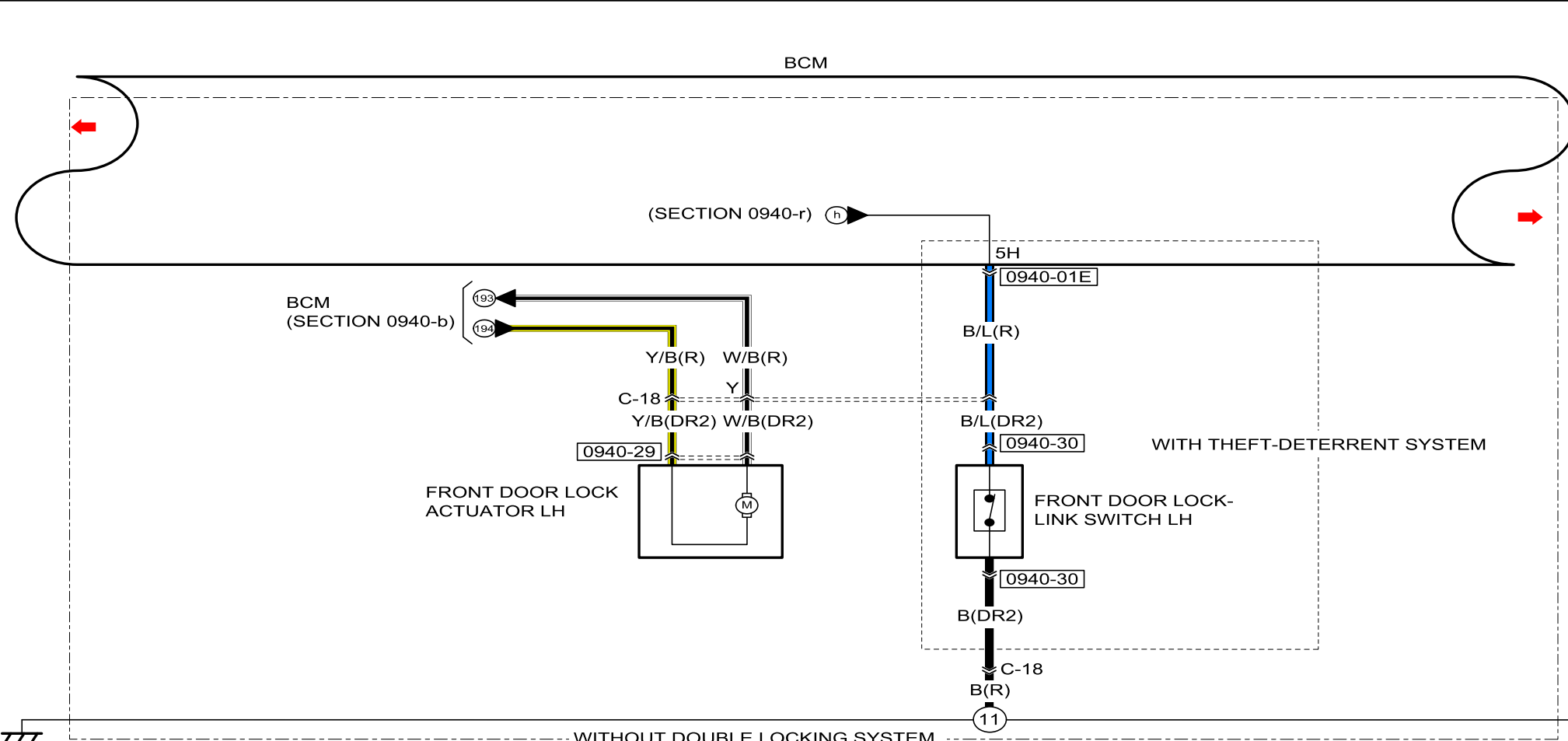

<p>0940-01E BCM</p> <p>WITH INTRUDER SENSOR : W B</p> <p>WITH THEFT-DETERRENT SYSTEM : B B</p> <p>WITH INTRUDER SENSOR : W B Y B</p> <p>U.K. specs., WITH MEMORY POWER SEAT : W</p> <p>5AB 5V 5S 5P 5M 5J 5G 5D 5A</p> <p>5AC 5Z 5W 5T 5Q 5N 5K 5H 5E 5B</p> <p>5AD 5AA 5X 5U 5R 5O 5L 5I 5F 5C</p> <p>DL GY L B O</p> <p>: U.K. specs.</p> <p>: AUTO REVERSE PINCH PROTECTION : DRIVER-SIDE WINDOW</p> <p>: WITH DOUBLE LOCKING SYSTEM</p> <p>: WITH HEATED OUTER MIRROR</p>	<p>0940-29 FRONT DOOR LOCK ACTUATOR LH</p>	<p>0940-30 FRONT DOOR LOCK-LINK SWITCH LH</p>			
---	--	---	--	--	--

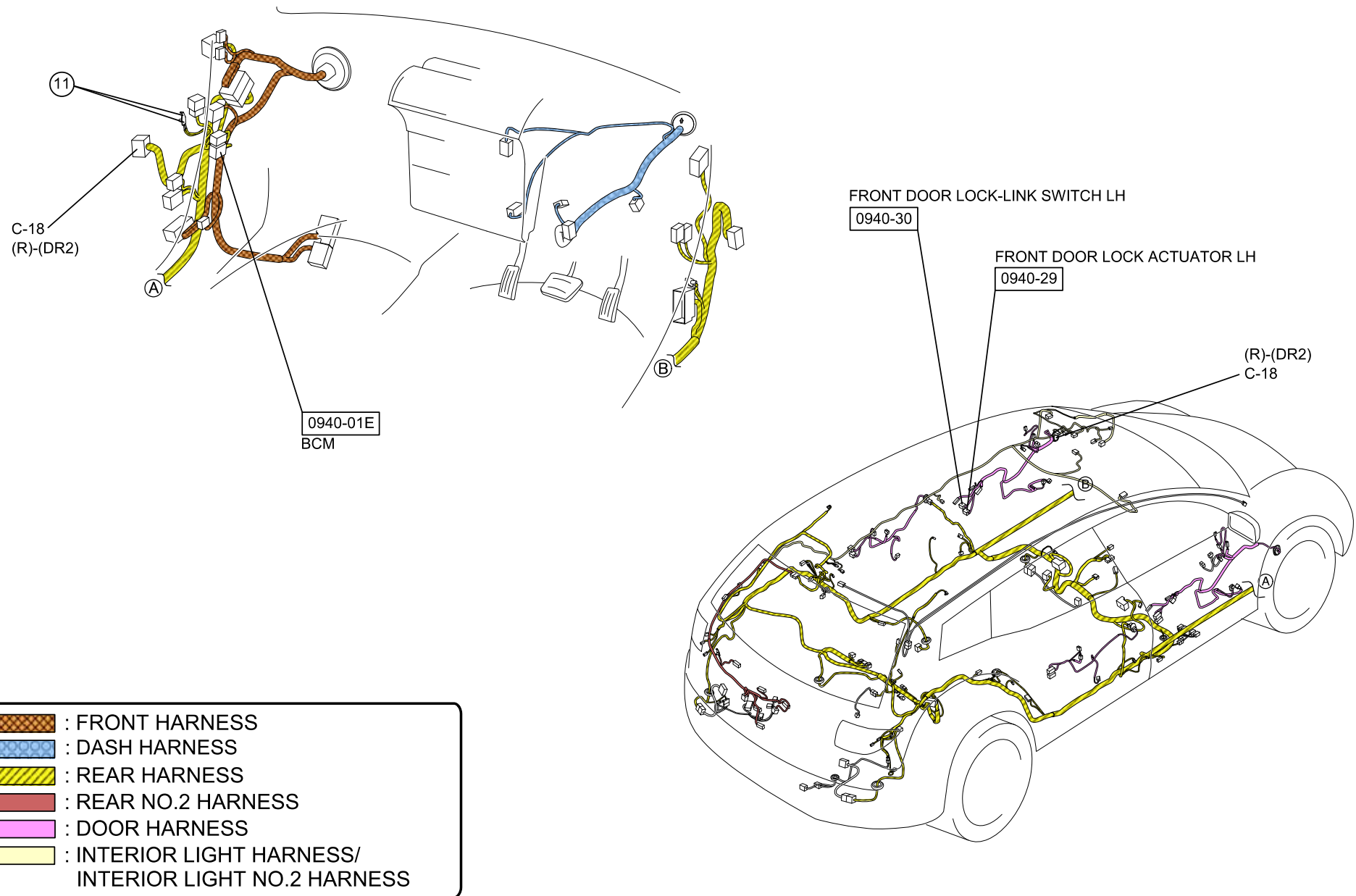

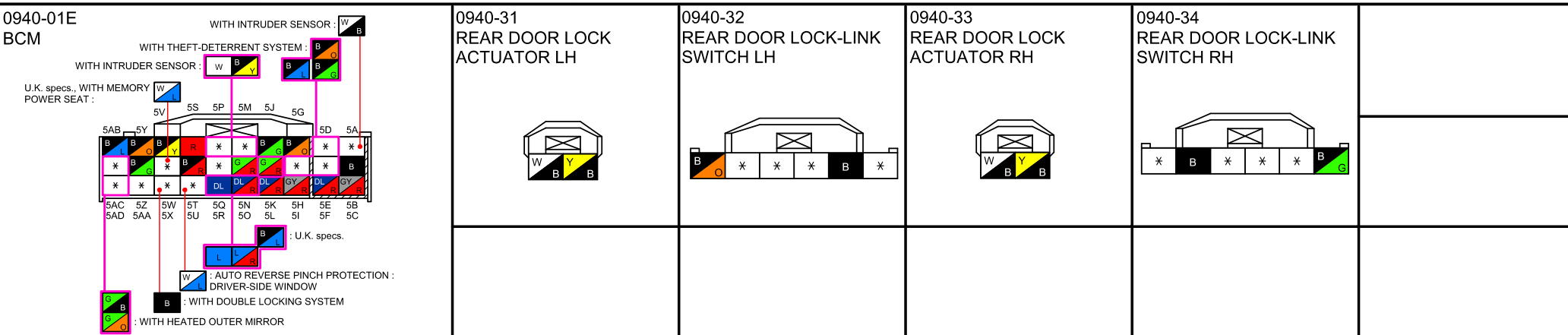

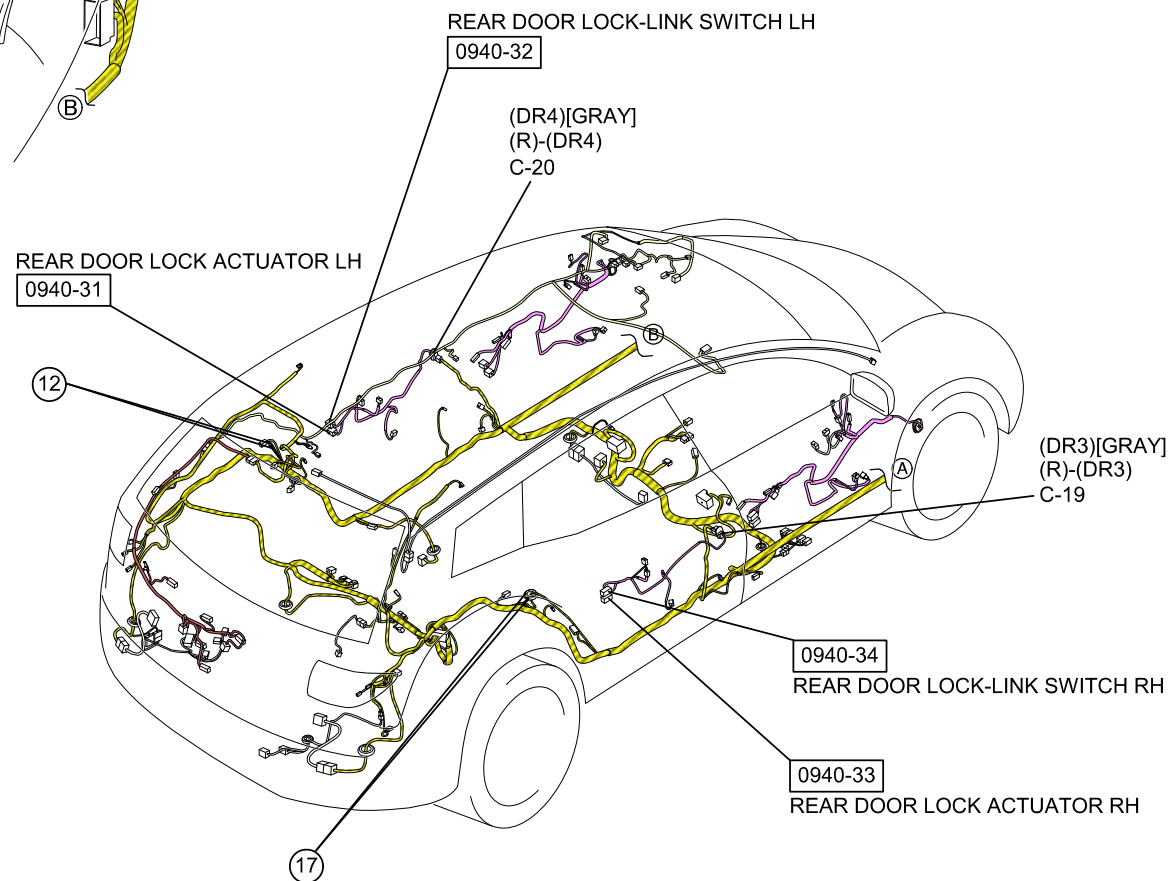
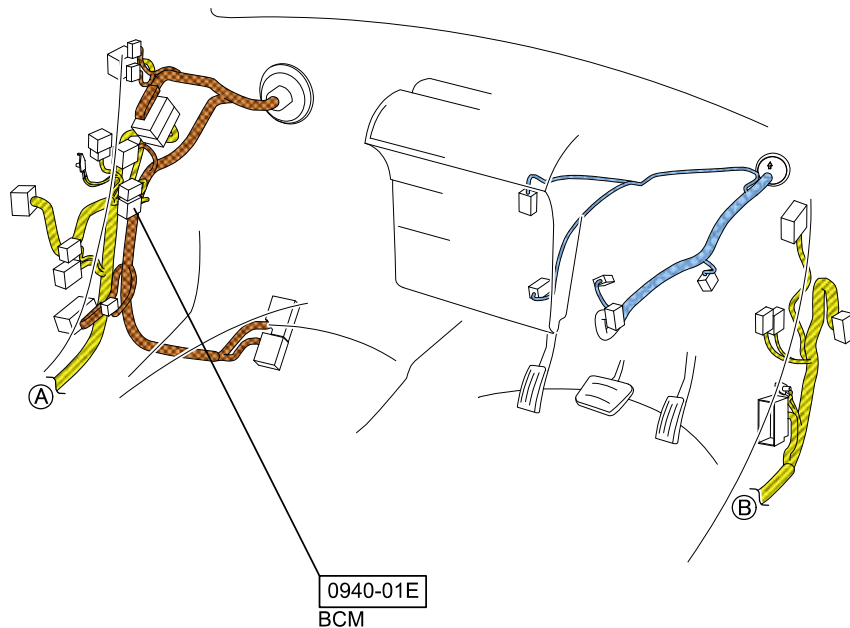

- : FRONT HARNESS
- : DASH HARNESS
- : REAR HARNESS
- : REAR NO.2 HARNESS
- : DOOR HARNESS
- : INTERIOR LIGHT HARNESS/
INTERIOR LIGHT NO.2 HARNESS